

LAKE BLUFF, GRASS LAKE, MI, 49240

<https://tuckerbenner.com>

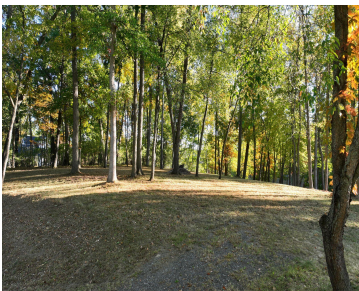
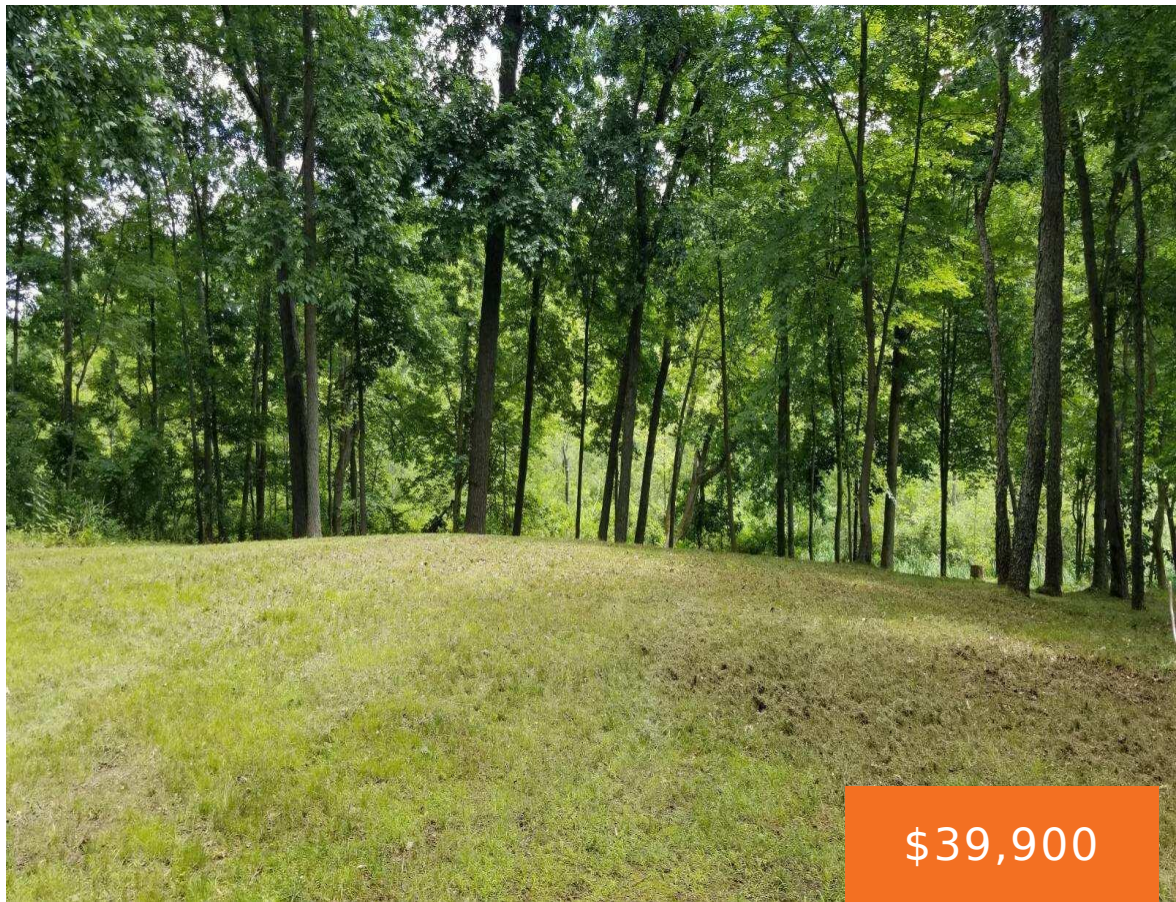

Start your summer build plans now with this beautiful one acre building site in the Tims Lake Development of Grass Lake. This lot is cleared, perc approved and ready for your home build. Access to Tims Lake and the common area walking trails is included. This lot is located on paved roads with three-minute access [...]

- 0 baths
- Lot
- Land
- Active



Basics

Category: Land
Status: Active
Lot size: 1.07 sq ft
Lot Size Acres: 1.07 acres

Type: Lot
Bathrooms: 0 baths
Subdivision Name: Tims Lake Preserve
County: Jackson



Call us now

Phone: (231)730-8781
Email: tuckerbennerteam@gmail.com
Address: 2747 Lakeshore Drive, Twin Lake, MI 49457



Amenities & Features

Utilities: None

Association Amenities: Beach Area, Boat Launch, Trail(s)

Waterfront Features: Channel, Lake

Lot Features: Buildable, Building, Cleared, Wooded

Fees & Taxes

Tax Assessed Value: \$13,755 **Association Fee Frequency:** Quarterly

Association Fee: \$106.30 **Tax Year:** 2024

Tax Annual Amount: \$725

School Information

High School District: Grass Lake

Miscellaneous

Road Surface Type: Paved

CrossStreet: Knight & Mount Hope

Attribution Contact: reBrokerBrad@gmail.com

Listing Terms: Cash, Conventional



Call us now

Phone: (231)730-8781

Email: tuckerbennerteam@gmail.com

Address: 2747 Lakeshore Drive, Twin Lake, MI 49457

