

MONROE, ALLEGAN, MI, 49010

https://tuckerbenner.com

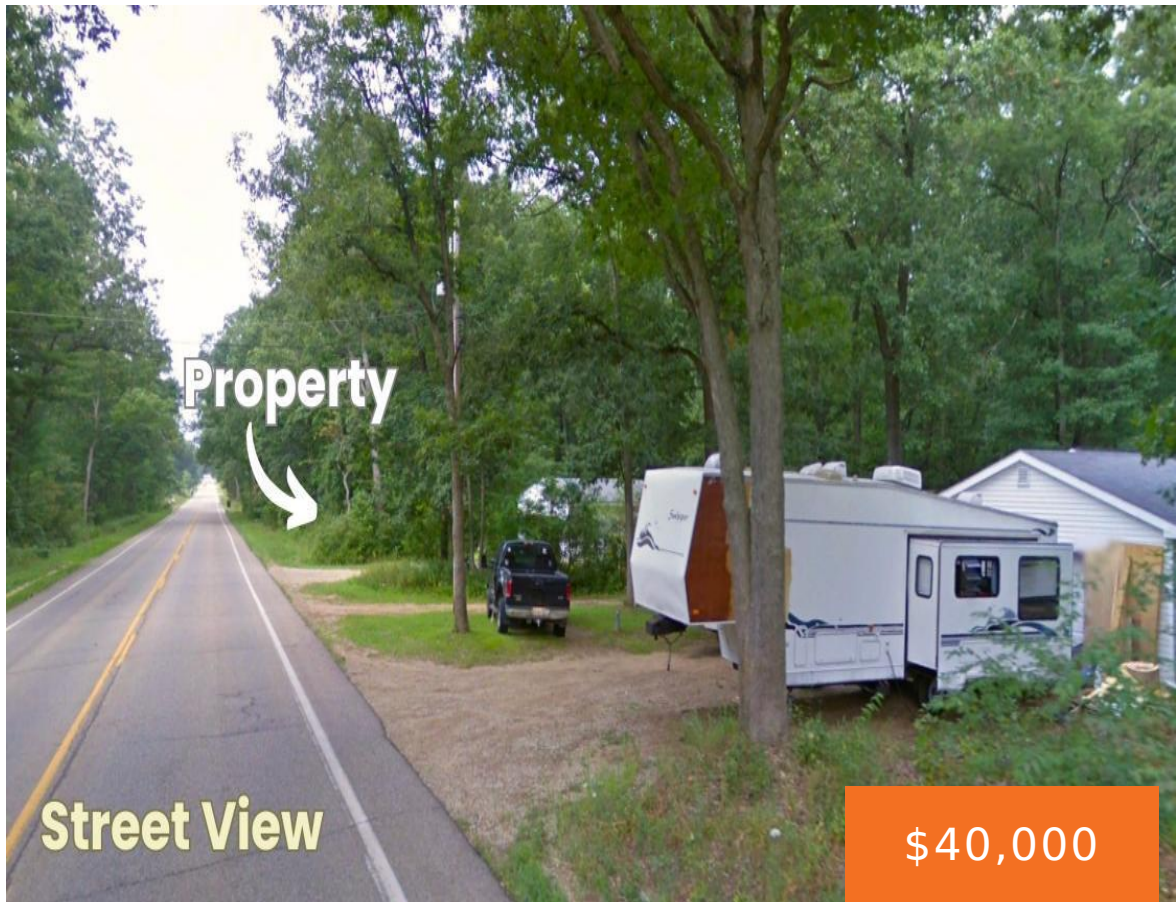

Two Beautiful 0.37-Acre Adjacent Parcels on Monroe Rd in Allegan, MI These adjacent parcels feature a scenic mix of wooded areas and open spaces, providing an excellent opportunity for building a home or creating a peaceful retreat. Located on Monroe Road in Allegan, MI, the land offers a quiet, rural atmosphere while still being close [...]

- 0 baths
- Commercial Land
- Land
- Active

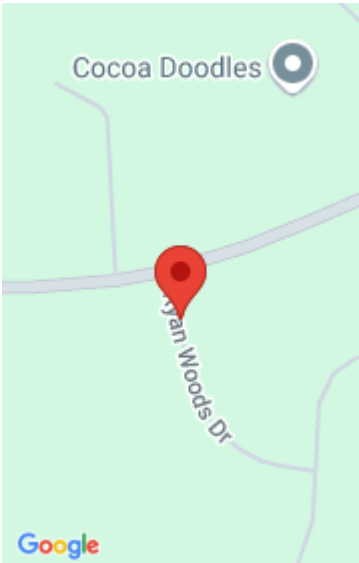

Call us now



Phone: (231)730-8781  
Email: tuckerbennerteam@gmail.com  
Address: 2747 Lakeshore Drive, Twin Lake, MI 49457



# Basics

**Category:** Land

**Status:** Active

**Lot size:** 0.37 sq ft

**County:** Allegan

**Type:** Commercial Land

**Bathrooms:** 0 baths

**Lot Size Acres:** 0.37 acres

# Amenities & Features

**Utilities:** Phone Available, Water Available, Sewer Available, Electricity Available, Phone Connected, Water Connected, Sewer Connected, Electricity Connected

# Fees & Taxes

**Tax Assessed Value:** \$183

**Tax Year:** 2024

**Tax Annual Amount:** \$183

# School Information

**High School District:** Allegan County ISD

**HighSchool:** Allegan

**Middle Or Junior School:** L.E. White

**Elementary School:** West Ward

# Miscellaneous

**CrossStreet:** 0 Monroe Road

**Listing Terms:** Cash

Call us now