

PEBBLE, FENNVILLE, MI, 49408

https://tuckerbenner.com

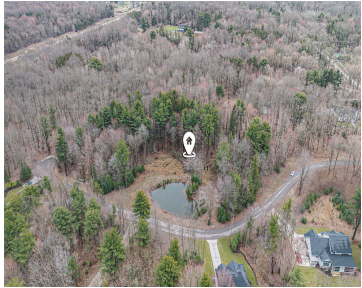

Nearly 4 acres of pure potential just blocks from Lake Michigan! Nestled in a quiet 8-lot neighborhood off Lakeshore Drive, this wooded parcel features a private pond and a peaceful stream meandering through the property. Multiple buildable areas offer flexibility for your dream home, whether you choose the north side of the stream or construct [...]

- 0 baths
- Acreage
- Land
- Active



Basics

Category: Land

Status: Active

Lot size: 3.68 sq ft

County: Allegan

Type: Acreage

Bathrooms: 0 baths

Lot Size Acres: 3.68 acres

Call us now



Phone: (231)730-8781

Email: tuckerbennerteam@gmail.com

Address: 2747 Lakeshore Drive, Twin Lake, MI 49457



Building Details

Sewer: Septic Tank

Current Use: Residential

Amenities & Features

Utilities: Natural Gas Available, Electricity Available, Cable Available, None

WaterSource: Well

Waterfront Features: Pond

Lot Features: Buildable, Wetland Area, Wooded

Fees & Taxes

Tax Assessed Value: \$52,589

Tax Annual Amount: \$2,770.25

Tax Year: 2024

Association Fee Includes: None

School Information

High School District: Fennville

Miscellaneous

Road Surface Type: Paved

Listing Terms: Cash, Conventional

CrossStreet: Lakeshore &126th Ave

Call us now



Phone: (231)730-8781

Email: tuckerbennerteam@gmail.com

Address: 2747 Lakeshore Drive, Twin Lake, MI 49457

