

GRUBER, MONROE, MI, 48162

<https://tuckerbenner.com>

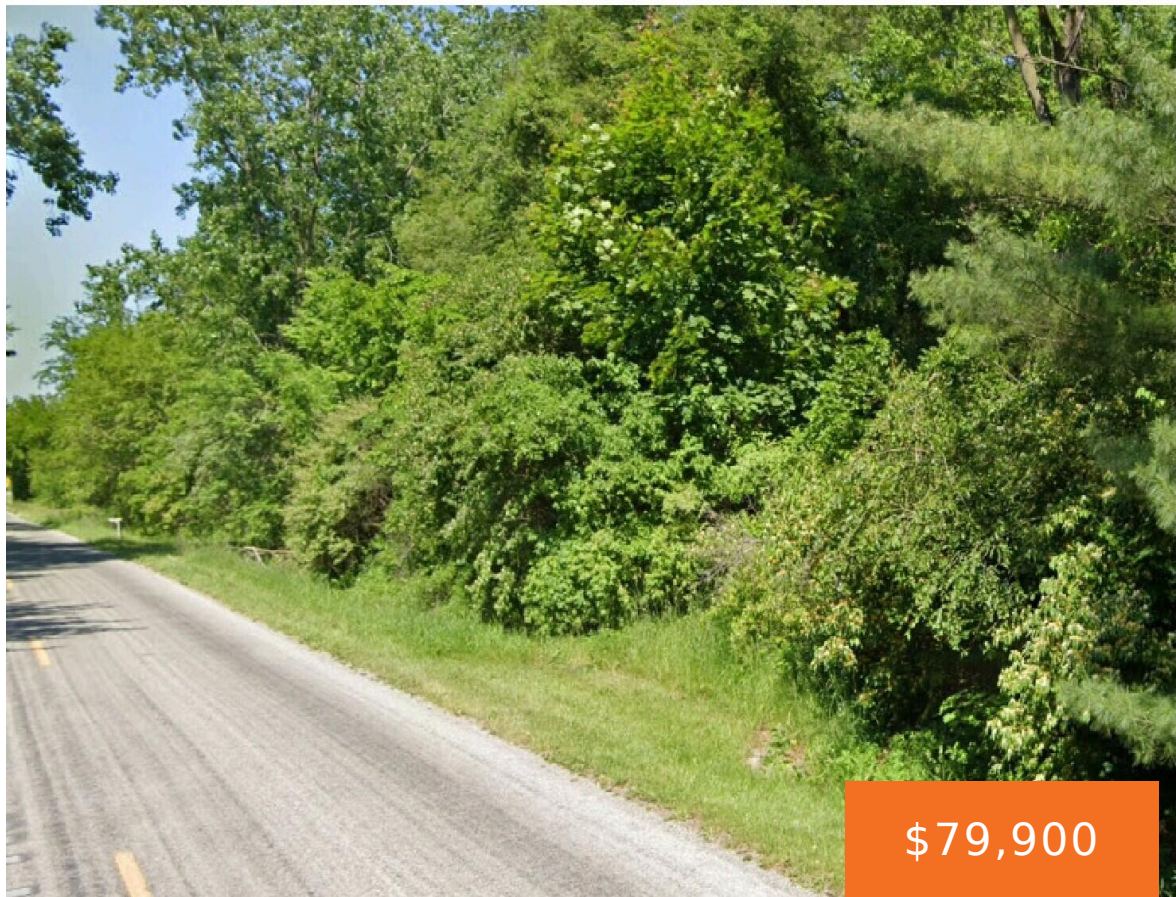

\$79,900



WOODLAND RETREAT with city Amenities! Over 2 Wooded acres in highly desirable Raisinville Twp. Property has Electric, Gas, City water, cable and has been tested positively for a drainfield. Culvert and driveway are in place. All it needs is for you to build your dream home here! Raisinville elementary and Monroe secondary schools. Just down [...]

- 0 baths
- Acreage
- Land
- Active

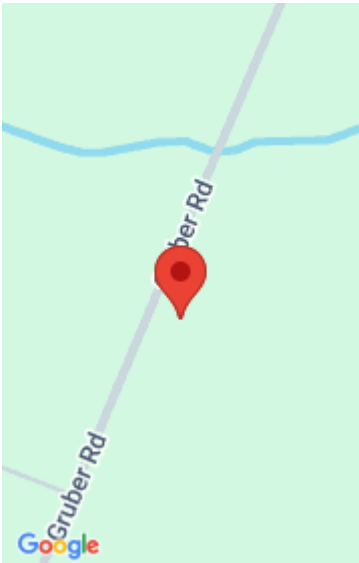

Call us now



Phone: (231)730-8781

Email: tuckerbennerteam@gmail.com

Address: 2747 Lakeshore Drive, Twin Lake, MI 49457



Basics

Category: Land

Status: Active

Lot size: 2.16 sq ft

County: Monroe

Type: Acreage

Bathrooms: 0 baths

Lot Size Acres: 2.16 acres

Amenities & Features

Utilities: Water Available, None

Lot Features: Buildable, Wooded

Fees & Taxes

Tax Assessed Value: \$18,411

Tax Year: 2024

Tax Annual Amount: \$777

School Information

High School District: Monroe

Elementary School: Raisinville

Miscellaneous

Road Surface Type: Paved

CrossStreet: Blue Bush Rd. & Heiss

Listing Terms: Cash, Conventional

Call us now