

SARSI, EVART, MI, 49631

<https://tuckerbenner.com>

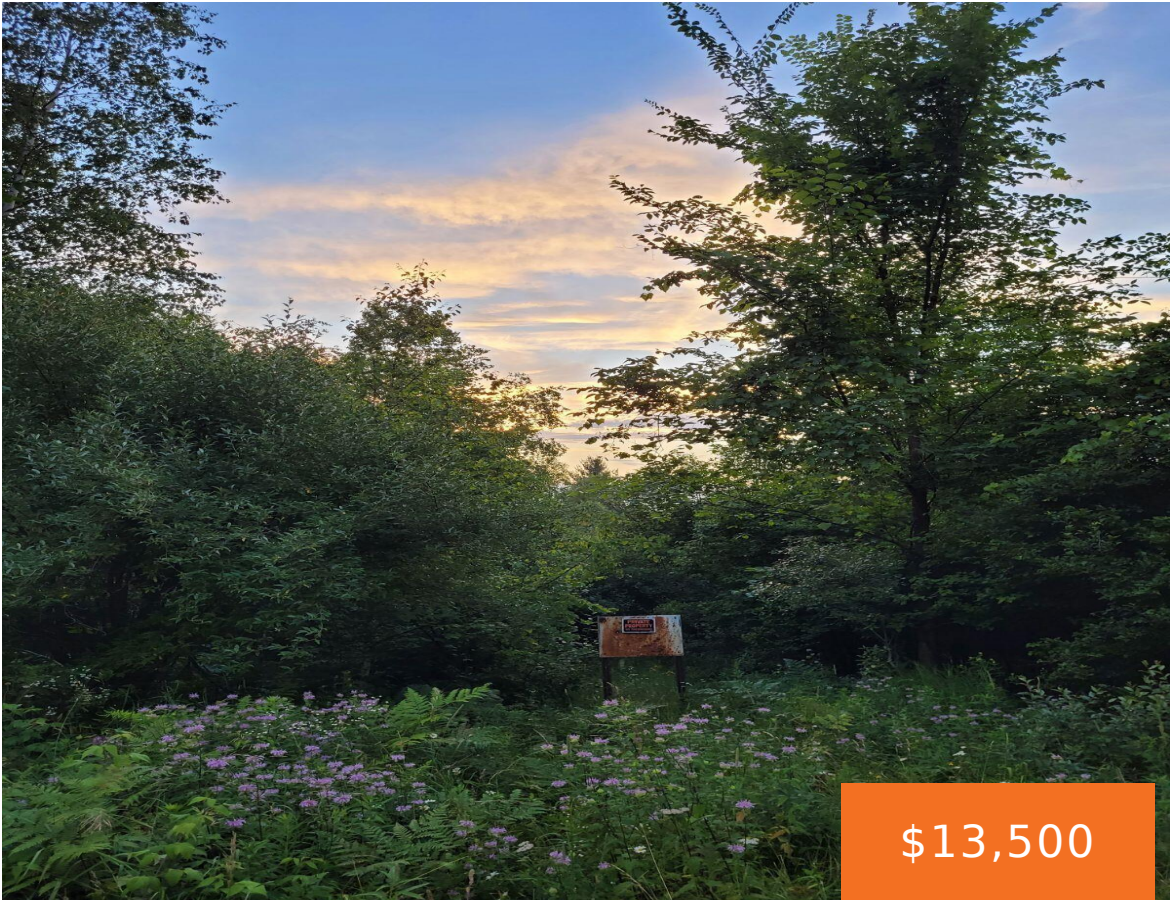

NINE beautifully wooded, buildable, adjacent lots at Lake Miramichi totaling about 4.2 acres. There are high spots overlooking a lush valley, a couple of blinds and tons of big deer. Ownership comes with access to the private all sports lakes for fishing, boating and watersports. HOA amenities include maintenance of the lakes, roads, garbage drop [...]

- 0 baths
- Lot
- Land
- Active



Basics

Category: Land **Type:** Lot
Status: Active **Bathrooms:** 0 baths
Lot size: 4.2 sq ft **Subdivision Name:** Lake Miramichi Subdivision No 4
Lot Size Acres: 4.2 acres **County:** Osceola



Call us now

Phone: (231)730-8781
 Email: tuckerbennerteam@gmail.com
 Address: 2747 Lakeshore Drive, Twin Lake, MI 49457



Building Details

Current Use: Recreational, Hunting

Amenities & Features

Utilities: None

Association Amenities: Beach Area, Campground

Waterfront Features: Lake **Lot Features:** Rolling Hills, Buildable, Cul-De-Sac, Recreational, Wooded, Corner Lot

Fees & Taxes

Tax Assessed Value: \$5,775

Association Fee Frequency: Annually

Association Fee: \$1,326

Tax Year: 2024

Tax Annual Amount: \$266

School Information

High School District: Ewart

Miscellaneous

Road Surface Type: Unimproved

CrossStreet: Shoshone Trail

Listing Terms: Cash, Conventional



Call us now

Phone: (231)730-8781

Email: tuckerbennerteam@gmail.com

Address: 2747 Lakeshore Drive, Twin Lake, MI 49457

