

SHOREWOOD, COVERT, MI, 49043

https://tuckerbenner.com

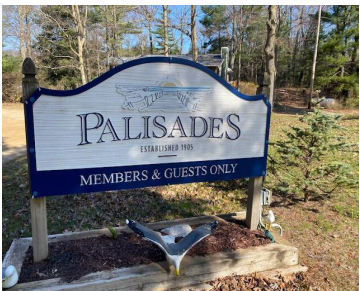
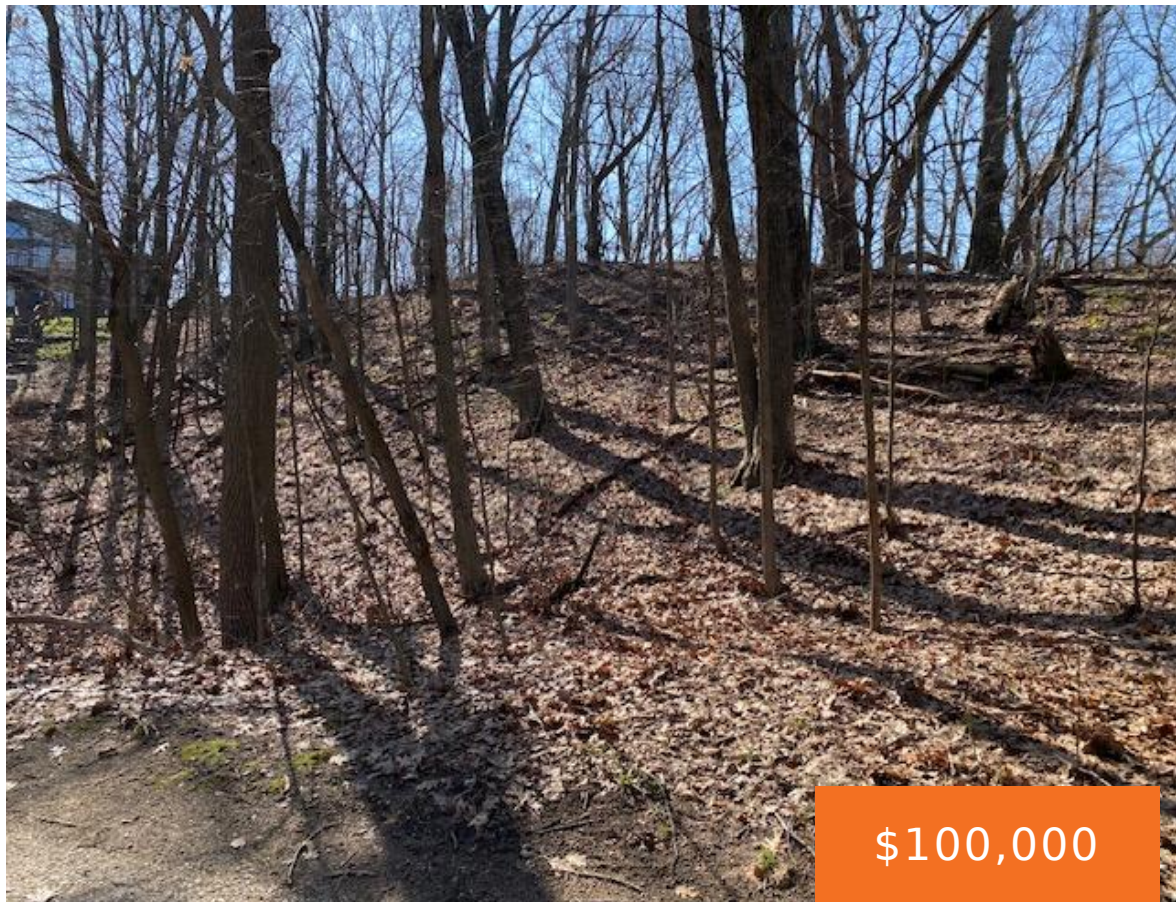

Lake Mich access in idyllic Palisades Park! Awesome building site comprises two large adjacent parcels in quiet wooded area, steps away from park stairs down to outstanding beach. Such a great place to spend your summers with tennis (hardcourt and clay), pickleball, boating, a Clubhouse, Soda Bar, Restaurant, ball field, activities for all ages. Surround [...]

- 0 baths
- Lot
- Land
- Active



Basics

**Category:** Land  
**Status:** Active  
**Lot size:** 1 sq ft  
**Lot Size Acres:** 1 acres

**Type:** Lot  
**Bathrooms:** 0 baths  
**Subdivision Name:** Palisades Park Country Club  
**County:** Van Buren



**Call us now**  
Phone: (231)730-8781  
Email: tuckerbennerteam@gmail.com  
Address: 2747 Lakeshore Drive, Twin Lake, MI 49457



---

## Amenities & Features

**Utilities:** Electricity Available, None    **Association Amenities:** Beach Area, Pets Allowed, Restaurant/Bar, Tennis Court(s), Clubhouse

**Waterfront Features:** Lake

**Lot Features:** Wooded

---

## Fees & Taxes

**Tax Assessed Value:** \$7,300

**Association Fee Frequency:** Annually

**Association Fee:** \$450

**Tax Year:** 2024

**Tax Annual Amount:** \$352.86

**Association Fee Includes:** Trash, Water

---

## School Information

**High School District:** Covert

---

## Miscellaneous

**Road Surface Type:** Unimproved

**CrossStreet:** 29th St and end

**Listing Terms:** Cash, Conventional



### Call us now

Phone: (231)730-8781

Email: tuckerbennerteam@gmail.com

Address: 2747 Lakeshore Drive, Twin Lake, MI 49457

