

# 1005, BOARDWALK CV, MUSKEGON, MI, 49441

<https://tuckerbenner.com>



\$140,000

Discover the perfect canvas for your vision with this water facing buildable lot. Ideal for builders and developers seeking an exceptional investment opportunity, or a buyer looking to build their dream home in a great location. This parcel promises endless possibilities in a highly sought-after location, nestled between the prestigious Hartshorn Marina and the prestigious [...]

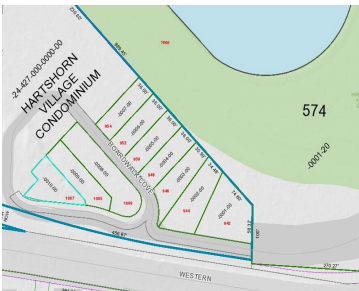

- 0 baths
- Acreage
- Land
- Active



Call us now

Phone: (231)730-8781  
Email: [tuckerbennerteam@gmail.com](mailto:tuckerbennerteam@gmail.com)  
Address: 2747 Lakeshore Drive, Twin Lake, MI 49457

# Basics

**Category:** Land

**Status:** Active

**Lot size:** 0.04 sq ft

**County:** Muskegon

**Type:** Acreage

**Bathrooms:** 0 baths

**Lot Size Acres:** 0.04 acres

# Building Details

**Sewer:** Public Sewer

# Amenities & Features

**Utilities:** Cable Available, Natural Gas Connected, Phone Available, Electricity Connected

**WaterSource:** Public

**Waterfront Features:** Lake

**Lot Features:** Level, Buildable, Cleared, Cul-De-Sac, Sidewalk

# Fees & Taxes

**Tax Assessed Value:** \$13,531

**Tax Annual Amount:** \$786

**Tax Year:** 2024

# School Information

**High School District:** Muskegon

# Miscellaneous

Call us now

**CrossStreet:** Western & Division

**Listing Terms:** Cash, Conventional

**Call us now**



Phone: (231)730-8781  
Email: tuckerbennerteam@gmail.com  
Address: 2747 Lakeshore Drive, Twin Lake, MI 49457

