

10370, HEATHERLAWN, JEROME, MI, 49249

<https://tuckerbenner.com>

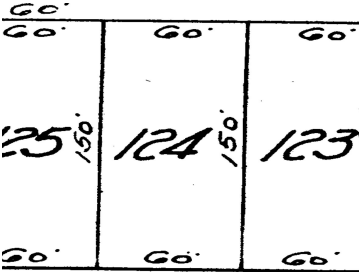

\$6,500



- 0 baths
- Lot
- Land
- Active

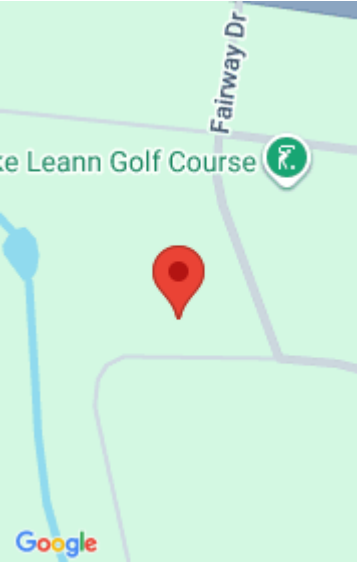

Call us now

Phone: (231)730-8781
Email: tuckerbennerteam@gmail.com
Address: 2747 Lakeshore Drive, Twin Lake, MI 49457



Basics

Category: Land

Status: Active

Lot size: 0.21 sq ft

County: Hillsdale

Type: Lot

Bathrooms: 0 baths

Lot Size Acres: 0.21 acres

Amenities & Features

Utilities: Electricity Available, None **Association Amenities:** Beach Area, Pets Allowed, Boat Launch

Waterfront Features: Lake

Lot Features: Buildable, Golf Community

Fees & Taxes

Tax Assessed Value: \$869

Association Fee: \$170

Tax Annual Amount: \$39

Association Fee Frequency: Annually

Tax Year: 2024

School Information

High School District: Addison

Miscellaneous

CrossStreet: Fairway Dr

Listing Terms: Cash

Call us now



Phone: (231)730-8781

Email: tuckerbennerteam@gmail.com

Address: 2747 Lakeshore Drive, Twin Lake, MI 49457

