

# 10883, VERDANT, ALLENDALE, MI, 49401

<https://tuckerbenner.com>

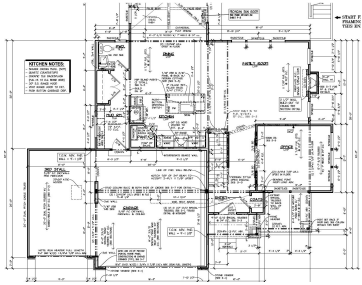

Envision yourself in this Stockton home plan located in the exceptionally designed community, Emerald Springs. In addition to its custom look and feel, this home features a: third stall garage, fireplace, Michigan room with beams, and Gorgeous Quartz Island, just to name a few. You'll find yourself relaxing in the multi-window Michigan room, watching the [...]

- 5 beds
- 4 baths
- Single Family Residence
- Residential
- Active
- 3089 sq ft



## Basics



### Call us now

Phone: (231)730-8781  
Email: [tuckerbennerteam@gmail.com](mailto:tuckerbennerteam@gmail.com)  
Address: 2747 Lakeshore Drive, Twin Lake, MI 49457



**Category:** Residential

**Status:** Active

**Bathrooms:** 4 baths

**Lot size:** 0.25 sq ft

**Subdivision Name:** Emerald Springs

**Lot Size Acres:** 0.25 acres

**County:** Ottawa

**Type:** Single Family Residence

**Bedrooms:** 5 beds

**Area:** 3089 sq ft

**Year built:** 2024

**Bathrooms Full:** 3

**Rooms Total:** 15

**Bathrooms Half:** 1

---

## Building Details

**Building Area Total:** 2274 sq ft

**Architectural Style:** Craftsman

**Heating:** Forced Air

**Basement:** Walk-Out Access

**Construction Materials:** Vinyl Siding

**Sewer:** Public Sewer

**Stories:** 2

---

## Amenities & Features

**Laundry Features:** Upper Level

**Waterfront Features:** Other

**Garage Spaces:** 3

**Appliances:** Refrigerator, Range, Microwave, Disposal, Dishwasher

**Window Features:** Low-Emissivity Windows, Screens, Insulated Windows

**Fireplaces Total:** 1

**Parking Features:** Attached

**Fireplace Features:** Family Room

**WaterSource:** Public

**Interior Features:** Garage Door Opener, Humidifier, Kitchen Island, Eat-in Kitchen, Pantry

**Exterior Features:** Porch(es), Deck(s)

**Cooling:** SEER 13 or Greater, Central Air

---

## Fees & Taxes

**Association Fee Frequency:** Annually

**Association Fee:** \$800



### Call us now

Phone: (231)730-8781

Email: tuckerbennerteam@gmail.com

Address: 2747 Lakeshore Drive, Twin Lake, MI 49457



---

## School Information

**High School District:** Allendale

---

## Miscellaneous

**Road Surface Type:** Paved

**CrossStreet:** Lake MI Dr and 60th St

**Listing Terms:** Cash, Conventional



### Call us now

Phone: (231)730-8781

Email: [tuckerbennerteam@gmail.com](mailto:tuckerbennerteam@gmail.com)

Address: 2747 Lakeshore Drive, Twin Lake, MI 49457

