

# 109, PADDOCK, GRAND RAPIDS, MI, 49506

<https://tuckerbenner.com>

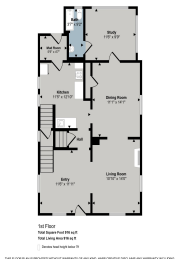

\$439,900



Welcome to 109 Paddock! 4 bed 2 bath home located in the highly desirable East Hills neighborhood. Walking distance to the farmer’s market, Cherry St, Wealthy St, and Eastown. This Traditional 2 story home has a front porch, back deck and off street parking. Inside you will find original hardwood floors with an updated kitchen [...]

- 4 beds
- 2 baths
- Single Family Residence
- Residential
- Active
- 1636 sq ft

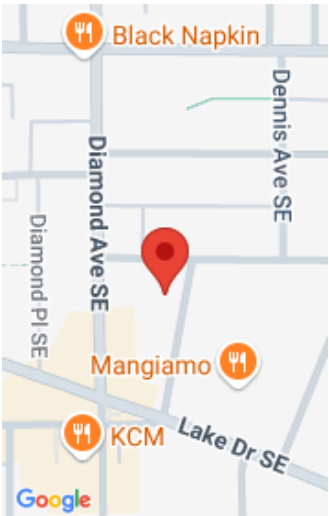

## Call us now



Phone: (231)730-8781  
Email: [tuckerbennerteam@gmail.com](mailto:tuckerbennerteam@gmail.com)  
Address: 2747 Lakeshore Drive, Twin Lake, MI 49457



# Basics

**Category:** Residential

**Status:** Active

**Bathrooms:** 2 baths

**Lot size:** 0.12 sq ft

**Bathrooms Full:** 2

**Rooms Total:** 9

**Type:** Single Family Residence

**Bedrooms:** 4 beds

**Area:** 1636 sq ft

**Year built:** 1915

**Lot Size Acres:** 0.12 acres

**County:** Kent

# Building Details

**Building Area Total:** 1636 sq ft

**Architectural Style:** Traditional

**Heating:** Forced Air

**Roof:** Composition

**Construction Materials:** Wood Siding

**Sewer:** Public

**Stories:** 2

**Basement:** Full

# Amenities & Features

**Laundry Features:** In Basement

**WaterSource:** Public

**Interior Features:** Pantry

**Fireplaces Total:** 1

**Fireplace Features:** Living Room

**Appliances:** Dishwasher, Dryer, Range, Refrigerator, Washer

**Patio And Porch Features:** Deck, Porch(es)

**Cooling:** Central Air

# Fees & Taxes

**Tax Assessed Value:** \$57,369

**Tax Annual Amount:** \$1,873.99

**Tax Year:** 2025

Call us now

---

# School Information

**High School District:** Grand Rapids

---

# Miscellaneous

**CrossStreet:** Hermitage      **Listing Terms:** Cash, FHA, VA Loan, MSHDA, Conventional

**Call us now**