

# 11276, CHICAGO, HOLLAND, MI, 49424

<https://tuckerbenner.com>

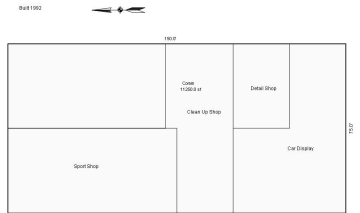

- 0 baths
- Retail/Commercial
- Commercial Lease
- Active

2,700 - 5,600 SF of Great Retail/Commercial space available for lease. Highly desirable area close to Walgreen's, numerous auto sales, restaurants, stores, and gas stations, makes this site an ideal location to lease! High Daily average traffic counts of 14,269 with easy access to Chicago Drive and 196 keep the traffic flowing.

## Basics

**Category:** Commercial Lease

**Status:** Active

**Lot size:** 1.22 sq ft

**Lot Size Acres:** 1.22 acres

**County:** Ottawa

**Type:** Retail/Commercial

**Bathrooms:** 0 baths

**Year built:** 1992

**Business Type:** Professional Service, Retail



### Call us now

Phone: (231)730-8781

Email: [tuckerbennerteam@gmail.com](mailto:tuckerbennerteam@gmail.com)

Address: 2747 Lakeshore Drive, Twin Lake, MI 49457



---

## Building Details

**Building Area Total:** 2700 sq ft

**Sewer:** Public Sewer

**Roof:** Metal

**Construction Materials:** Brick, Stone

**Heating:** None

**Number Of Buildings:** 1

---

## Amenities & Features

**Parking Total:** 10

**WaterSource:** Public

**Utilities:** Water Available, None

**Fireplaces Total:** 1

---

## Fees & Taxes

**Tax Assessed Value:** \$309,617

**Tax Year:** 2023

---

## School Information

**High School District:** West Ottawa

---

## Miscellaneous

**CrossStreet:** E Lakewood Blvd, 112th Ave



### Call us now

Phone: (231)730-8781

Email: tuckerbennerteam@gmail.com

Address: 2747 Lakeshore Drive, Twin Lake, MI 49457

