

11610, BAILEY, LOWELL, MI, 49331

<https://tuckerbenner.com>

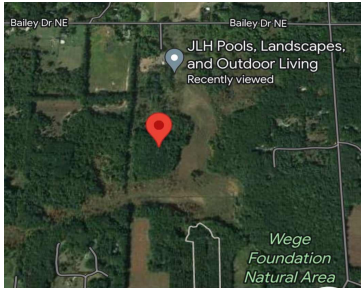

Beautiful rolling hill setting some wooded and some cleared. Hard to find larger parcel in Vergennes Township. Land is adjacent to another parcel of the same size to the South which backs up to the Wege Foundation Natural Area. Both Parcels can be purchased together.

- 0 baths
- Acreage
- Land
- Active



Basics

Category: Land

Status: Active

Lot size: 16.1 sq ft

County: Kent

Type: Acreage

Bathrooms: 0 baths

Lot Size Acres: 16.1 acres



Call us now

Phone: (231)730-8781

Email: tuckerbennerteam@gmail.com

Address: 2747 Lakeshore Drive, Twin Lake, MI 49457



Fees & Taxes

Tax Assessed Value: \$50,764

Tax Year: 2023

Tax Annual Amount: \$2,500

School Information

High School District: Lowell

Miscellaneous

CrossStreet: Vergennes

Listing Terms: Cash, Conventional



Call us now

Phone: (231)730-8781

Email: tuckerbennerteam@gmail.com

Address: 2747 Lakeshore Drive, Twin Lake, MI 49457

