

11610, BAILEY, LOWELL, MI, 49331

<https://tuckerbenner.com>

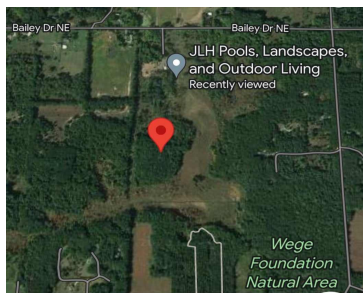

Beautiful rolling hill setting some wooded and some cleared. Hard to find larger parcel in Vergennes Township. Two 16.15 acre parcels joined together with an easement for ingress and egress. Land backs up to the Wege Foundation Natural Area

- 0 baths
- Acreage
- Land
- Active



Basics

Category: Land

Status: Active

Lot size: 16.16 sq ft

County: Kent

Type: Acreage

Bathrooms: 0 baths

Lot Size Acres: 16.16 acres



Call us now

Phone: (231)730-8781
 Email: tuckerbennerteam@gmail.com
 Address: 2747 Lakeshore Drive, Twin Lake, MI 49457



Building Details

Current Use: Recreational

Amenities & Features

Lot Features: Cleared, Wooded

Fees & Taxes

Tax Assessed Value: \$50,764

Tax Year: 2022

Tax Annual Amount: \$4,600

School Information

High School District: Lowell

Miscellaneous

CrossStreet: M21

Listing Terms: Cash, Conventional



Call us now

Phone: (231)730-8781

Email: tuckerbennerteam@gmail.com

Address: 2747 Lakeshore Drive, Twin Lake, MI 49457

