

11773, NEWCASTLE, CANADIAN LAKES, MI, 49346

<https://tuckerbenner.com>

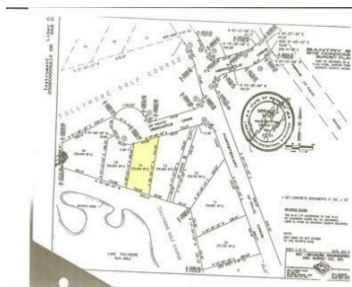

Outstanding building site on the Nationally ranked (13th in Country of Public Courses by Golf Digest in 2007-08). Overlooking the 4th green and Lake Tullymore, lot has southern exposure, elevated view and in the most prestigious community. As part of the Canadian Lakes Community you are entitled to FREE golf on our two 9 hole [...]

- 0 baths
- Lot
- Land
- Active

Basics

Category: Land

Status: Active

Lot size: 0.53 sq ft

County: Mecosta

Type: Lot

Bathrooms: 0 baths

Lot Size Acres: 0.53 acres



Call us now

Phone: (231)730-8781

Email: tuckerbennerteam@gmail.com

Address: 2747 Lakeshore Drive, Twin Lake, MI 49457



Building Details

Current Use: Residential

Amenities & Features

Association Amenities: Clubhouse, Airport Landing Strip, Baseball Diamond, Beach Area, Fitness Center, Library, Meeting Room, Pets Allowed, Restaurant/Bar, Sauna, Security, Skiing, Storage, Indoor Pool, Tennis Court(s), Other

Lot Features: Buildable, Golf Community, Golf Course Frontage, Recreational

Waterfront Features: All Sports, Assoc Access, No Wake, Private Frontage

Fees & Taxes

Tax Assessed Value: \$12,600

Association Fee: \$803

Tax Annual Amount: \$570

Association Fee Frequency: Annually

Tax Year: 2022

Association Fee Includes: Snow Removal

School Information

High School District: Chippewa Hills

Miscellaneous

Road Surface Type: Paved

Listing Terms: Cash, Conventional

CrossStreet: Bantry Bay



Call us now

Phone: (231)730-8781

Email: tuckerbennerteam@gmail.com

Address: 2747 Lakeshore Drive, Twin Lake, MI 49457

