

# 12269, CORAL, CORAL, MI, 49322

https://tuckerbenner.com

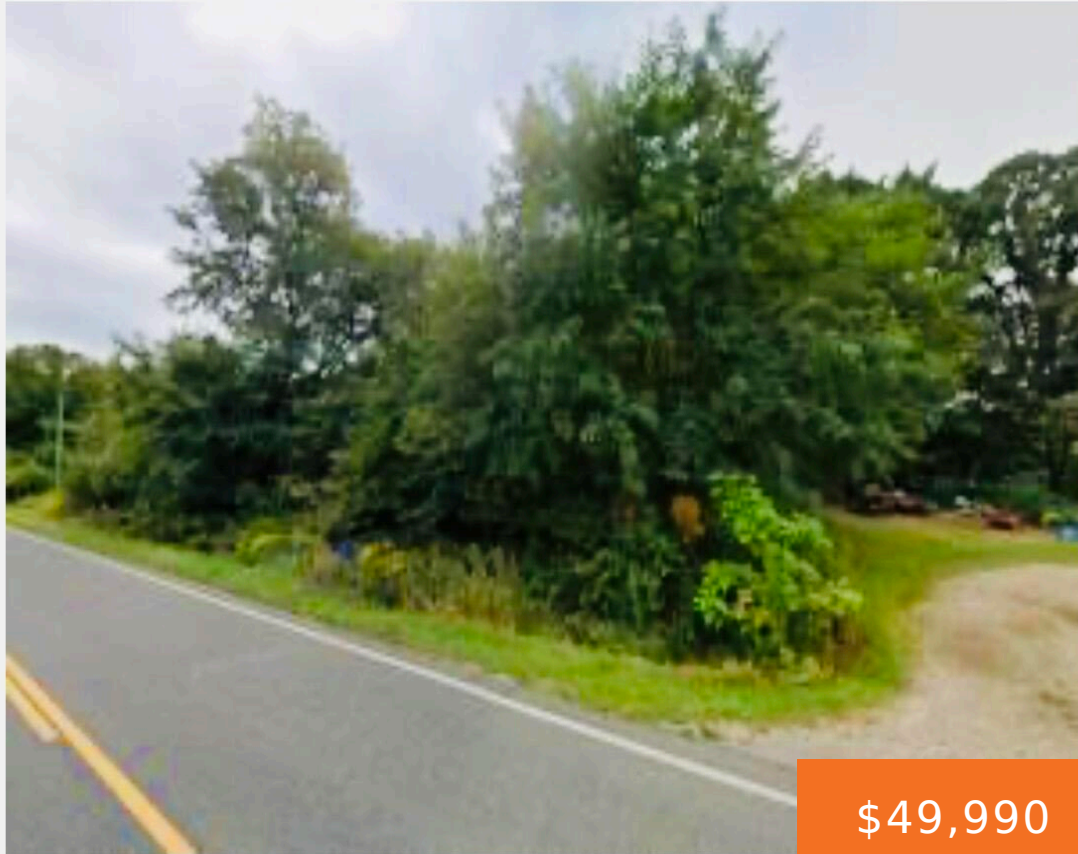

\$49,990

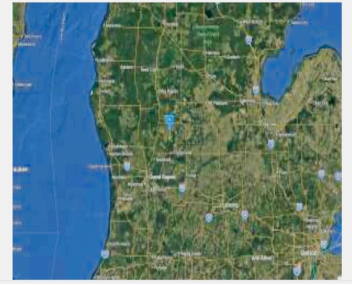
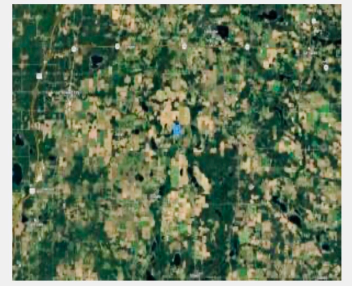

Fantastic Find in Coral, MI. This 0.9 Acre Lakefront lot is on private Rocky Lake. There is no Public Access to this lake. Offering a great opportunity to own lakefront property in a natural serene setting. Located close to Hunting, Town Center, and numerous amethysts. This wooded buildable parcel is off Coral Road for ease of [...]

- 0 baths
- Lot
- Land
- Active



## Basics

**Category:** Land

**Status:** Active

**Lot size:** 9.3 sq ft

**County:** Montcalm

**Type:** Lot

**Bathrooms:** 0 baths

**Lot Size Acres:** 9.3 acres

## Call us now



Phone: (231)730-8781  
 Email: tuckerbennerteam@gmail.com  
 Address: 2747 Lakeshore Drive, Twin Lake, MI 49457



---

## Amenities & Features

**Utilities:** None

**Waterfront Features:** Lake

**Lot Features:** Rolling Hills, Buildable, Wooded

---

## Fees & Taxes

**Tax Assessed Value:** \$4,972

**Tax Year:** 2025

**Tax Annual Amount:** \$391

---

## School Information

**High School District:** Lakeview

**HighSchool:** Lakeview High School

**Middle Or Junior School:** Lakeview Middle School

**Elementary School:** Lakeview Elementary School

---

## Miscellaneous

**Road Surface Type:** Paved

**CrossStreet:** Gravel Ridge Road & Coral Road

**Listing Terms:** Cash, Conventional

### Call us now



Phone: (231)730-8781

Email: tuckerbennerteam@gmail.com

Address: 2747 Lakeshore Drive, Twin Lake, MI 49457

