

123, CASTLE RIDGE, BATTLE CREEK, MI, 49015

<https://tuckerbenner.com>

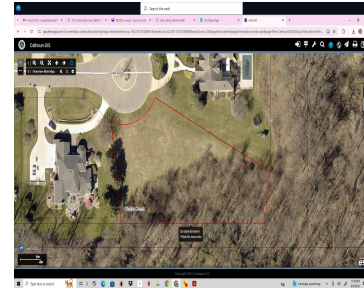

Nestled in one of the most sought-after neighborhoods, this nearly one-acre parcel offers the perfect canvas to create your dream home. Situated on a serene cul-de-sac, the property is surrounded by luxurious homes, each exemplifying the high standard of living that defines this exclusive community. This prime location ensures privacy, tranquility, and a sense of [...]

- 0 baths
- Lot
- Land
- Active



Basics

Category: Land

Status: Active

Lot size: 0.86 sq ft

Lot Size Acres: 0.86 acres

Type: Lot

Bathrooms: 0 baths

Subdivision Name: Minges Hills

County: Calhoun



Call us now

Phone: (231)730-8781

Email: tuckerbennerteam@gmail.com

Address: 2747 Lakeshore Drive, Twin Lake, MI 49457



Building Details

Current Use: Residential

Amenities & Features

Utilities: Phone Available, Storm Sewer, Water Available, Sewer Available, Natural Gas Available, Electricity Available, Cable Available, Broadband, None

Lot Features: Level, Buildable, Cul-De-Sac, Wooded

Fees & Taxes

Tax Assessed Value: \$31,500

Association Fee Frequency: Annually

Association Fee: \$300

Tax Year: 2024

Tax Annual Amount: \$2,091.34

School Information

High School District: Lakeview-Calhoun Co

Miscellaneous

Road Surface Type: Paved

CrossStreet: Beckley and Minges Hills Dr

Listing Terms: Cash, Conventional



Call us now

Phone: (231)730-8781

Email: tuckerbennerteam@gmail.com

Address: 2747 Lakeshore Drive, Twin Lake, MI 49457

