

12329, WAGON WHEEL, CANADIAN LAKES, MI, 49346

<https://tuckerbenner.com>

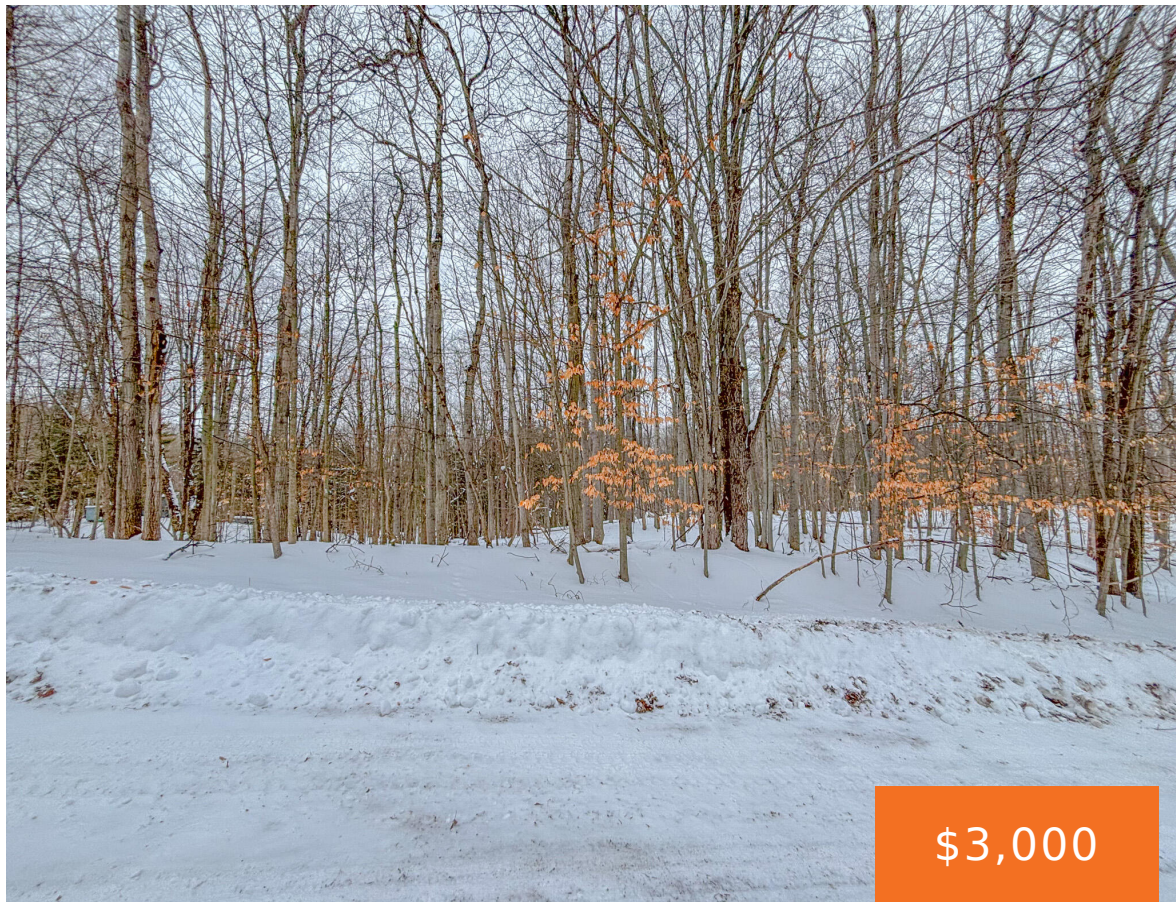

Build your dream retreat on this scenic vacant lot featuring rolling hills, abundant trees, and peaceful seclusion. Tucked away in a quiet area with little nearby development, yet just minutes from Highlands Golf Course and the Canadian Lakes Castle. Ideal for those seeking privacy without sacrificing resort-style amenities. M-20 is less than a mile away [...]

- 0 baths
- Lot
- Land
- Active

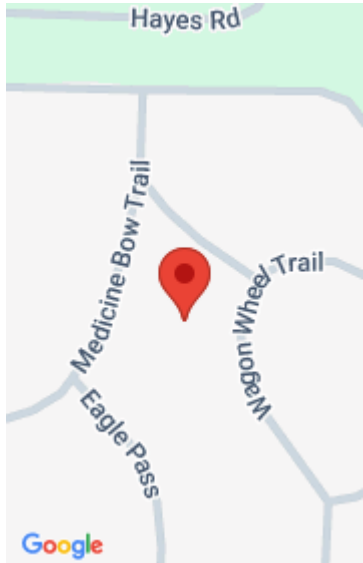

Basics

Category: Land
Status: Active
Lot size: 0.43 sq ft
Lot Size Acres: 0.43 acres

Type: Lot
Bathrooms: 0 baths
Subdivision Name: Lost Canyon
County: Mecosta

Building Details

Current Use: Residential

Amenities & Features

Utilities: Natural Gas Available, Electricity Available, Cable Available, Phone Available, None

Waterfront Features: Lake, Pond, Stream/Creek

Association Amenities: Airport Landing Strip, Baseball Diamond, Beach Area, Campground, Fitness Center, Golf Membership, Indoor Pool, Library, Meeting Room, Pets Allowed, Restaurant/Bar, Security, Spa/Hot Tub, Storage, Tennis Court(s), Boat Launch, Other, Clubhouse, Pool, Sauna, Trail(s)

Lot Features: Rolling Hills, Buildable, Wooded

Fees & Taxes

Tax Assessed Value: \$618
Association Fee: \$872
Tax Annual Amount: \$25

Association Fee Frequency: Annually
Tax Year: 2024
Association Fee Includes: Snow Removal, Other

School Information

High School District: Chippewa Hills

Call us now

Miscellaneous

Road Surface Type: Paved **CrossStreet:** Wagon Wheel x Medicine Lodge
Listing Terms: Cash, Conventional

Call us now



Phone: (231)730-8781
Email: tuckerbennerteam@gmail.com
Address: 2747 Lakeshore Drive, Twin Lake, MI 49457

