

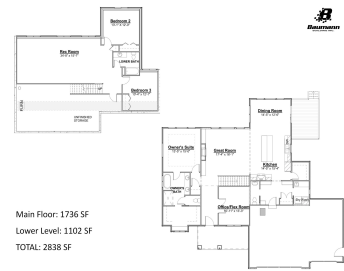

\$725,000

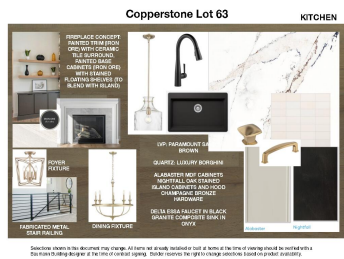

Main Floor: 1736 SF
Lower Level: 1102 SF
TOTAL: 2838 SF

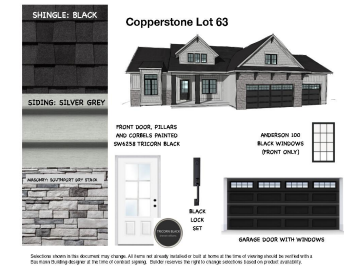

Dreaming of a brand-new home in Grand Haven? This stunning property in Baumann Building's sought-after Copperstone community is currently under construction and ready to make your dreams a reality! This beautiful Thornapple floorplan features 2 bedrooms and 1.5 baths on the main floor and 2 bedrooms and a full bath on the lower level. The [...]

- 4 beds
- 3 baths
- Single Family Residence
- Residential
- Active
- 2838 sq ft



Basics



Call us now

Phone: (231)730-8781
Email: tuckerbennerteam@gmail.com
Address: 2747 Lakeshore Drive, Twin Lake, MI 49457



Category: Residential

Status: Active

Bathrooms: 3 baths

Lot size: 0.64 sq ft

Subdivision Name: Copperstone

Lot Size Acres: 0.64 acres

County: Ottawa

Type: Single Family Residence

Bedrooms: 4 beds

Area: 2838 sq ft

Year built: 2024

Bathrooms Full: 2

Rooms Total: 7

Bathrooms Half: 1

Building Details

Building Area Total: 1736 sq ft **Construction Materials:** Stone, Vinyl Siding

Architectural Style: Ranch **Sewer:** Public Sewer

Heating: Forced Air **Stories:** 1

Basement: Daylight

Amenities & Features

Laundry Features: Laundry Room, Main Level **Parking Features:** Garage Door Opener, Attached

Fireplace Features: Gas Log, Living Room **Garage Spaces:** 3

WaterSource: Public **Appliances:** Refrigerator, Range, Microwave, Dishwasher

Exterior Features: Porch(es), Deck(s) **Fireplaces Total:** 1

Cooling: Central Air

Fees & Taxes

Association Fee: \$1,450

School Information



Call us now

Phone: (231)730-8781

Email: tuckerbennerteam@gmail.com

Address: 2747 Lakeshore Drive, Twin Lake, MI 49457



High School District: Grand Haven

Miscellaneous

CrossStreet: Copperway Dr & Boulderway Trl **Listing Terms:** Cash, FHA, VA Loan, Conventional



Call us now

Phone: (231)730-8781

Email: tuckerbennerteam@gmail.com

Address: 2747 Lakeshore Drive, Twin Lake, MI 49457

