

136, 19TH, HOLLAND, MI, 49423

<https://tuckerbenner.com>

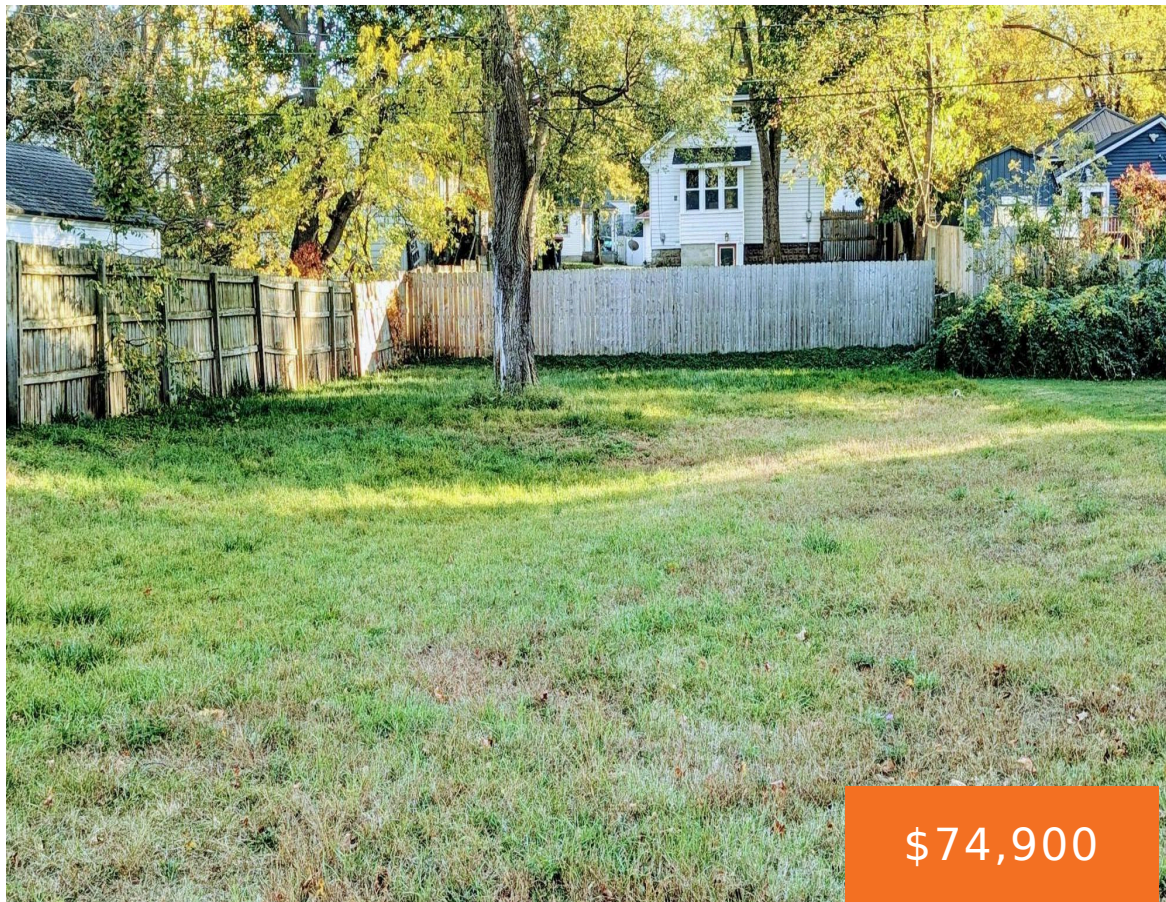

Prime Vacant Lot - Build Your Dream Home on this rarely available Holland City lot, offering endless possibilities! Level & situated on a picturesque, tree-lined street, it's zoned for both single-family & multi-family builds, perfect for a stunning personal residence or a lucrative investment property. Whether you're a homeowner looking to create your dream home [...]

- 0 baths
- Lot
- Land
- Active



## Basics

**Category:** Land

**Status:** Active

**Lot size:** 0.14 sq ft

**County:** Ottawa

**Type:** Lot

**Bathrooms:** 0 baths

**Lot Size Acres:** 0.14 acres



### Call us now

Phone: (231)730-8781

Email: [tuckerbennerteam@gmail.com](mailto:tuckerbennerteam@gmail.com)

Address: 2747 Lakeshore Drive, Twin Lake, MI 49457



---

## Building Details

**Current Use:** Residential

---

## Amenities & Features

**Utilities:** Phone Available, Storm Sewer, Water Available, Sewer Available, Broadband

**Lot Features:** Buildable, Sidewalk, Wooded

---

## Fees & Taxes

**Tax Assessed Value:** \$18,936

**Tax Year:** 2024

**Tax Annual Amount:** \$1,216

---

## School Information

**High School District:** Holland

---

## Miscellaneous

**Road Surface Type:** Paved

**CrossStreet:** College Ave & Columbia Ave

**Listing Terms:** Cash, Conventional



### Call us now

Phone: (231)730-8781

Email: [tuckerbennerteam@gmail.com](mailto:tuckerbennerteam@gmail.com)

Address: 2747 Lakeshore Drive, Twin Lake, MI 49457

