

14043, FULTON, LOWELL, MI, 49331

<https://tuckerbenner.com>

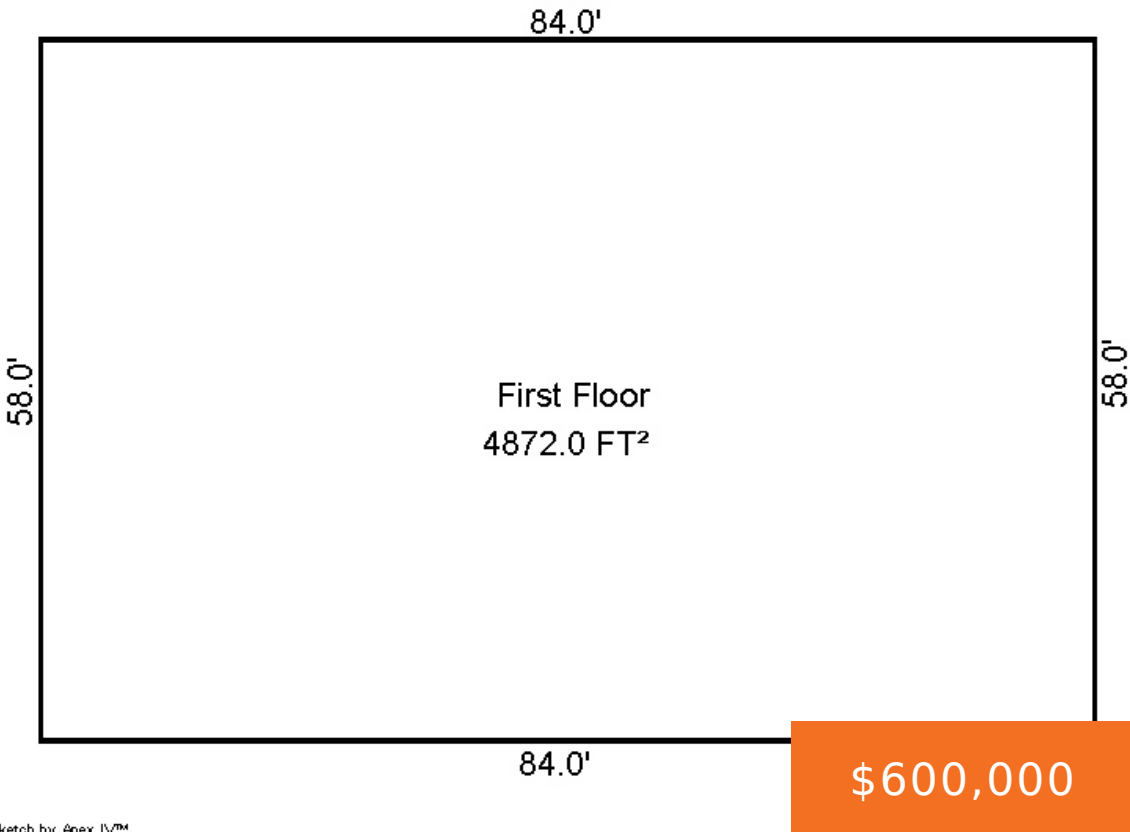

Sketch by Apex IV™



Exceptional commercial real estate offering in Lowell Township on highly desirable Fulton Street. Over 5,000 square feet on 9.75 acres, this versatile property includes warehouse space, full utilities, accessibility features, a new water heater, and abundant parking. The expansive site and strategic location provide outstanding potential for a variety of commercial uses. Ready for immediate [...]

- 1 bath
- Industrial
- Commercial Sale
- Active

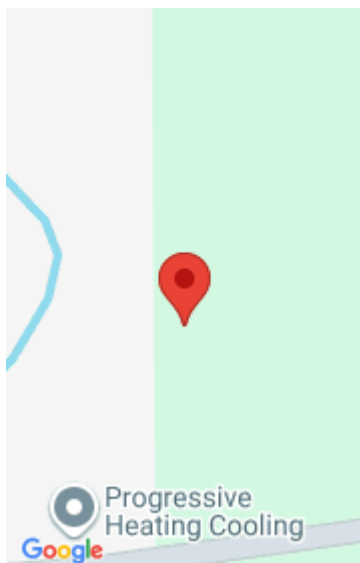

Call us now

Phone: (231)730-8781
Email: tuckerbennerteam@gmail.com
Address: 2747 Lakeshore Drive, Twin Lake, MI 49457



Basics

Category: Commercial Sale

Status: Active

Lot size: 9.75 sq ft

Bathrooms Full: 1

Business Type: Auto Service, Distribution, Storage, Retail, Manufacturing

Type: Industrial

Bathrooms: 1 bath

Year built: 1986

Lot Size Acres: 9.75 acres

County: Kent

Building Details

Building Area Total: 5606 sq ft

Construction Materials: Vinyl Siding

Heating: Forced Air

Foundation Details: Slab

Number Of Units Total: 1

Sewer: Septic Tank

StoriesTotal: 5606

Number Of Buildings: 1

Amenities & Features

Inclusions: Real Estate **Utilities:** Phone Available, Natural Gas Available, Electricity Available, Cable Available, Phone Connected, Natural Gas Connected, Electricity Connected

WaterSource: Well

Cooling: Central Air

Fees & Taxes

Tax Assessed Value: \$80,626

Tax Year: 2025

Tax Annual Amount: \$2,414

School Information

Call us now



Phone: (231)730-8781

Email: tuckerbennerteam@gmail.com

Address: 2747 Lakeshore Drive, Twin Lake, MI 49457



High School District: Lowell

Miscellaneous

Road Surface Type: Paved

CrossStreet: Montcalm & James St

Listing Terms: Conventional, Cash

Call us now



Phone: (231)730-8781

Email: tuckerbennerteam@gmail.com

Address: 2747 Lakeshore Drive, Twin Lake, MI 49457

