

# 143, SHERMAN, MUSKEGON, MI, 49444

https://tuckerbenner.com

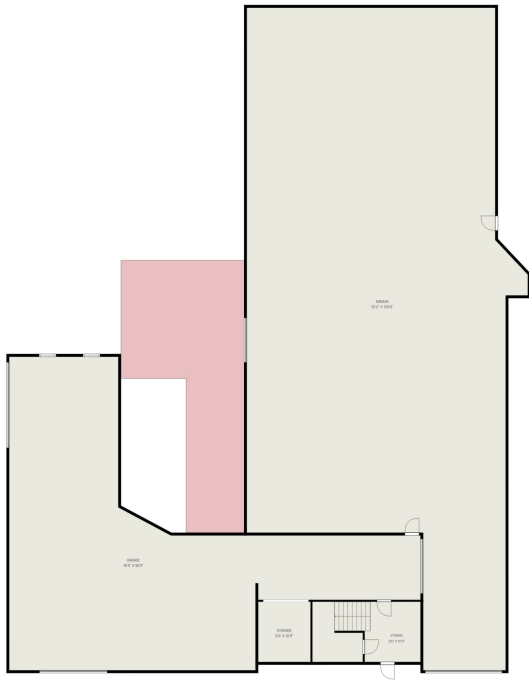

**TOTAL: 397 sq. ft**  
1st floor: 0 sq. ft, 2nd floor: 397 sq. ft  
EXCLUDED AREAS: GARAGE: 7050 sq. ft, STORAGE: 748 sq. ft, HALL: 1538 sq. ft,  
ROOM: 426 sq. ft, UTILITY: 54 sq. ft, WORKSHOP: 28766 sq. ft,  
WALLS: 937 sq. ft

ALL IMAGES, DIMENSIONS, AND OTHER INFORMATION CONTAINED HEREIN ARE APPROXIMATE AND FOR ILLUSTRATIVE PURPOSES ONLY. AND SHALL NOT BE RELIED UPON BY ANY PARTY. BEST LOOK PHOTOS MAKES NO REPRESENTATIONS OR WARRANTIES, AND DISCLAIMS ANY AND ALL LIABILITY ARISING FROM USE OF THIS INFORMATION. ALL INFORMATION HEREIN SHALL BE SUBJECT TO THE TERMS AND CONDITIONS FOUND AT NEXTDOORPHOTOS.COM/TC.

**\$400**



Prime industrial warehouse space available for lease at 143 W Sherman in Muskegon, MI! Located on a highly trafficked road ensuring excellent visibility, this property is ideal for storage, light manufacturing, small-scale workshops, entrepreneurial ventures, or contractor use. Unit 2 is available on the main floor, offering an 18' x 15' space equipped with an [...]

- 0 baths
- Industrial
- Commercial Lease
- Active



## Basics

**Category:** Commercial Lease    **Type:** Industrial  
**Status:** Active    **Bathrooms:** 0 baths  
**Lot size:** 1.94 sq ft    **Year built:** 1920  
**Lot Size Acres:** 1.94 acres    **Business Type:** Auto Service, Professional Service, Storage, Manufacturing, Distribution  
**County:** Muskegon

### Call us now



Phone: (231)730-8781  
Email: tuckerbennerteam@gmail.com  
Address: 2747 Lakeshore Drive, Twin Lake, MI 49457



---

## Building Details

**Building Area Total:** 100935 sq ft

**Construction Materials:** Brick, Stone

**Building Features:** Bath Common Area

**Number Of Units Total:** 1

**Heating:** Forced Air

**Number Of Buildings:** 1

---

## Amenities & Features

**Utilities:** Natural Gas Available, Electricity Available, Natural Gas Connected, Electricity Connected

**Fireplaces Total:** 1

**Parking Features:** Paved

**Cooling:** Central Air

---

## Fees & Taxes

**Tax Assessed Value:** \$255,819

**Tax Year:** 2025

---

## School Information

**High School District:** Muskegon Hts

---

## Miscellaneous

**CrossStreet:** Sherman and Sanford

### Call us now

Phone: (231)730-8781

Email: tuckerbennerteam@gmail.com

Address: 2747 Lakeshore Drive, Twin Lake, MI 49457

