

1431, M-89, OTSEGO, MI, 49078

<https://tuckerbenner.com>

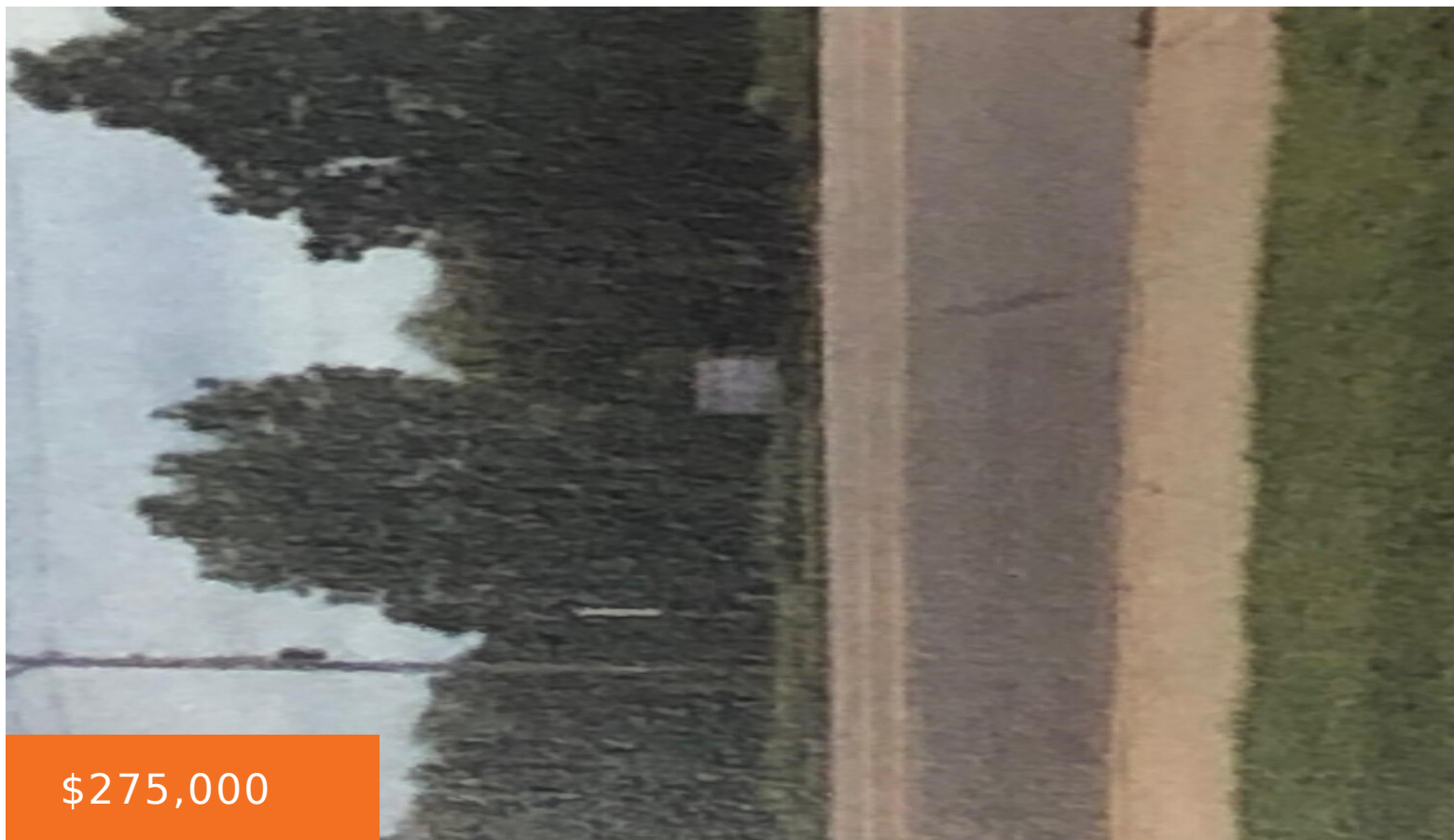

\$275,000

Great Development property on busy M-89 corridor

- 0 baths
- Acreage
- Land
- Active



Basics

Category: Land

Status: Active

Lot size: 13 sq ft

County: Allegan

Type: Acreage

Bathrooms: 0 baths

Lot Size Acres: 13 acres



Call us now

Phone: (231)730-8781

Email: tuckerbennerteam@gmail.com

Address: 2747 Lakeshore Drive, Twin Lake, MI 49457



Building Details

Current Use: Other

Fees & Taxes

Tax Assessed Value: \$39,000

Tax Year: 2022

Tax Annual Amount: \$1,674

School Information

High School District: Otsego

Miscellaneous

CrossStreet: US 131 & Pitcher

Listing Terms: Cash, Conventional



Call us now

Phone: (231)730-8781

Email: tuckerbennerteam@gmail.com

Address: 2747 Lakeshore Drive, Twin Lake, MI 49457

