

1500, KOOIMAN, GRAND HAVEN, MI, 49417

<https://tuckerbenner.com>

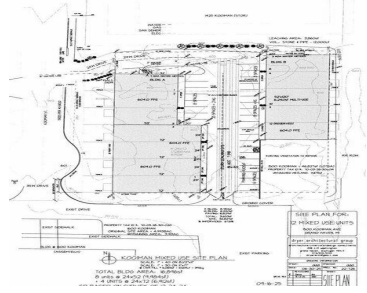

Welcome to Kooiman Place - a modern, forward-thinking development designed to seamlessly integrate living, working, and storage into one flexible space. Currently under construction, these innovative residential units offer a rare opportunity to create a lifestyle that balances home, business, and personal use all under one roof. Each unit offers available space of 1,248 sq. [...]

- 1 bed
- 2 baths
- Condominium
- Residential
- Active
- 672 sq ft



Basics

Call us now

Phone: (231)730-8781
 Email: tuckerbennerteam@gmail.com
 Address: 2747 Lakeshore Drive, Twin Lake, MI 49457



Category: Residential

Status: Active

Bathrooms: 2 baths

Lot size: 0 sq ft

Bathrooms Full: 1

Rooms Total: 5

Bathrooms Half: 1

Type: Condominium

Bedrooms: 1 bed

Area: 672 sq ft

Year built: 2026

Lot Size Acres: 0 acres

County: Ottawa

Building Details

Building Area Total: 1248 sq ft

Architectural Style: Contemporary

Heating: Forced Air

Basement: Slab

Construction Materials: Block, Other

Sewer: Public

Stories: 2

Amenities & Features

Laundry Features: Electric Dryer Hookup, Washer Hookup

Parking Features: Garage Door Opener, Attached

WaterSource: Public

Cooling: Central Air

Utilities: Natural Gas Available, Electricity Available, Cable Available, Storm Sewer

Garage Spaces: 1

Interior Features: Broadband, Garage Door Opener

Fees & Taxes

Association Fee Frequency: Monthly

Association Fee: \$95

Association Fee Includes: Snow Removal, Lawn/Yard Care

Call us now



Phone: (231)730-8781

Email: tuckerbennerteam@gmail.com

Address: 2747 Lakeshore Drive, Twin Lake, MI 49457



School Information

High School District: Grand Haven

Miscellaneous

CrossStreet: Hillcrest St & S Beacon Blvd

Listing Terms: Cash, Conventional

Call us now



Phone: (231)730-8781

Email: tuckerbennerteam@gmail.com

Address: 2747 Lakeshore Drive, Twin Lake, MI 49457

