

1511, HOME, FLINT, MI, 48505

<https://tuckerbenner.com>

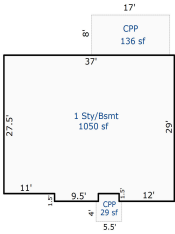

\$49,900



- 3 beds
- 2 baths
- Single Family Residence
- Residential
- Active
- 1042 sq ft

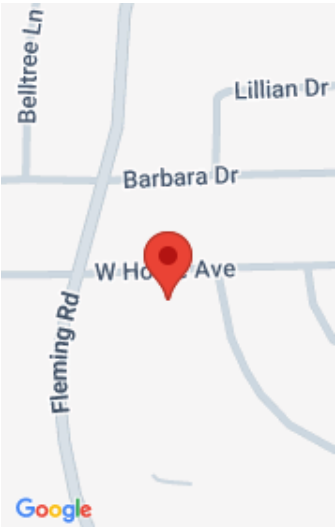

Call us now

Phone: (231)730-8781

Email: tuckerbennerteam@gmail.com

Address: 2747 Lakeshore Drive, Twin Lake, MI 49457

Basics

Category: Residential

Status: Active

Bathrooms: 2 baths

Lot size: 0.14 sq ft

Bathrooms Full: 1

Rooms Total: 6

Bathrooms Half: 1

Type: Single Family Residence

Bedrooms: 3 beds

Area: 1042 sq ft

Year built: 1959

Lot Size Acres: 0.14 acres

County: Genesee

Building Details

Building Area Total: 1042 sq ft

Architectural Style: Ranch

Heating: Forced Air

Basement: Full

Construction Materials: Brick

Sewer: Public

Stories: 1

Amenities & Features

Laundry Features: In Basement

WaterSource: Public

Fees & Taxes

Tax Assessed Value: \$10,160

Tax Annual Amount: \$991

Tax Year: 2024

School Information

High School District: Flint

Call us now

Miscellaneous

CrossStreet: Fleming **Listing Terms:** Cash, FHA, VA Loan, MSHDA, Conventional

Call us now



Phone: (231)730-8781
Email: tuckerbennerteam@gmail.com
Address: 2747 Lakeshore Drive, Twin Lake, MI 49457

