

15341, HOWARD CITY- EDMORE, HOWARD CITY, MI, 49329

<https://tuckerbenner.com>

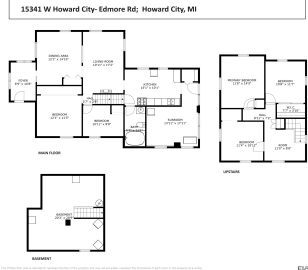

\$229,000



Super maintained 5-bedroom, 2-story home in Amble. Home has 2 bedrooms on main floor, and 3 bedrooms up. Mainfloor has a living room, eating room, spacious kitchen, and finished breezeway. In addition to a new 28 x 30 garage, and a reinforced 12 x 20 storage barn, the home's roof ventilation has been completely updated. [...]

- 5 beds
- 1 bath
- Single Family Residence
- Residential
- Active
- 1638 sq ft



Basics



Call us now

Phone: (231)730-8781
Email: tuckerbennerteam@gmail.com
Address: 2747 Lakeshore Drive, Twin Lake, MI 49457



Category: Residential

Status: Active

Bathrooms: 1 bath

Lot size: 0.4 sq ft

Bathrooms Full: 1

Rooms Total: 9

Type: Single Family Residence

Bedrooms: 5 beds

Area: 1638 sq ft

Year built: 1890

Lot Size Acres: 0.4 acres

County: Montcalm

Building Details

Building Area Total: 1638 sq ft

Architectural Style: Farm House

Heating: Forced Air

Basement: Crawl Space, Partial

Construction Materials: Block

Sewer: Septic System

Stories: 2

Amenities & Features

Laundry Features: In Basement

Utilities: Phone Available, Natural Gas Available, Electricity Available, Natural Gas Connected, High-Speed Internet

Parking Features: Garage Faces Rear, Detached

Garage Spaces: 2

WaterSource: Well

Interior Features: Ceiling Fans

Lot Features: Level

Window Features: Insulated Windows

Fees & Taxes

Tax Assessed Value: \$45,643

Tax Year: 2024

Tax Annual Amount: \$1,293

School Information



Call us now

Phone: (231)730-8781

Email: tuckerbennerteam@gmail.com

Address: 2747 Lakeshore Drive, Twin Lake, MI 49457



High School District: Lakeview-Montcalm Co

Miscellaneous

CrossStreet: Elm St **Listing Terms:** Cash, FHA, VA Loan, Rural Development, MSHDA, Conventional



Call us now

Phone: (231)730-8781

Email: tuckerbennerteam@gmail.com

Address: 2747 Lakeshore Drive, Twin Lake, MI 49457

