

1581, LONE PINE (WEST), BALDWIN, MI, 49304

<https://tuckerbenner.com>



Wonderful RANCH home offers a peaceful setting with public access to Wolf Lake and many inland Lakes. Close proximity to Lake Michigan Sugar Sand Beaches. Many recent updates, provide you with a fresh space that feels like new. As you step inside, you'll immediately appreciate the open, airy feel of the living spaces, featuring bright [...]

- 2 beds
- 1 bath
- Single Family Residence
- Residential
- Active
- 1552 sq ft

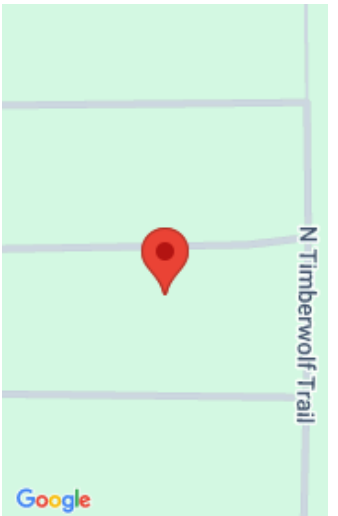

Basics

Category: Residential	Type: Single Family Residence
Status: Active	Bedrooms: 2 beds
Bathrooms: 1 bath	Area: 1552 sq ft
Lot size: 0.47 sq ft	Year built: 2008
Bathrooms Full: 1	Lot Size Acres: 0.47 acres
Rooms Total: 7	County: Lake

Building Details

Building Area Total: 1552 sq ft	Construction Materials: Block, Concrete, Vinyl Siding
Architectural Style: Ranch	Sewer: Septic Tank
Heating: Forced Air, Other	Stories: 1
Roof: Shingle	Basement: Slab

Amenities & Features

Laundry Features: Laundry Room, Main Level	Flooring: Engineered Hardwood, Laminate, Tile
Utilities: Electricity Available, Phone Connected, Cable Connected, High-Speed Internet	Fencing: Fenced Back, Front Yard, Full, Privacy
Parking Features: Detached	Fireplace Features: Gas/Wood Stove
Garage Spaces: 34	WaterSource: Well
Appliances: Dishwasher, Dryer, Microwave, Range, Refrigerator, Washer	Interior Features: Ceiling Fan(s), LP Tank Rented, Eat-in Kitchen
Lot Features: Level, Recreational, Wooded	Window Features: Screens, Insulated Windows, Garden Window, Window Treatments
Patio And Porch Features: 3 Season Room, Covered, Enclosed, Patio, Porch(es), Screened	Exterior Features: Scrn Porch, Other
Cooling: Central Air	

Call us now



Fees & Taxes

Tax Assessed Value: \$40,246
Tax Annual Amount: \$981.70

Tax Year: 2024



School Information

High School District: Baldwin



Miscellaneous

Road Surface Type: Unimproved **CrossStreet:** M-37 N
Listing Terms: Cash, FHA, VA Loan, Rural Development, MSHDA, Conventional

Call us now