

168TH, SPRING LAKE, MI, 49456

https://tuckerbenner.com

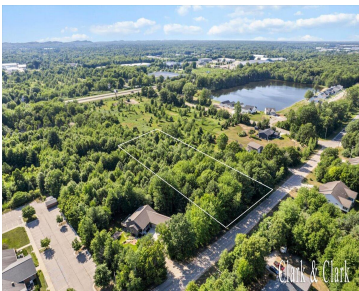
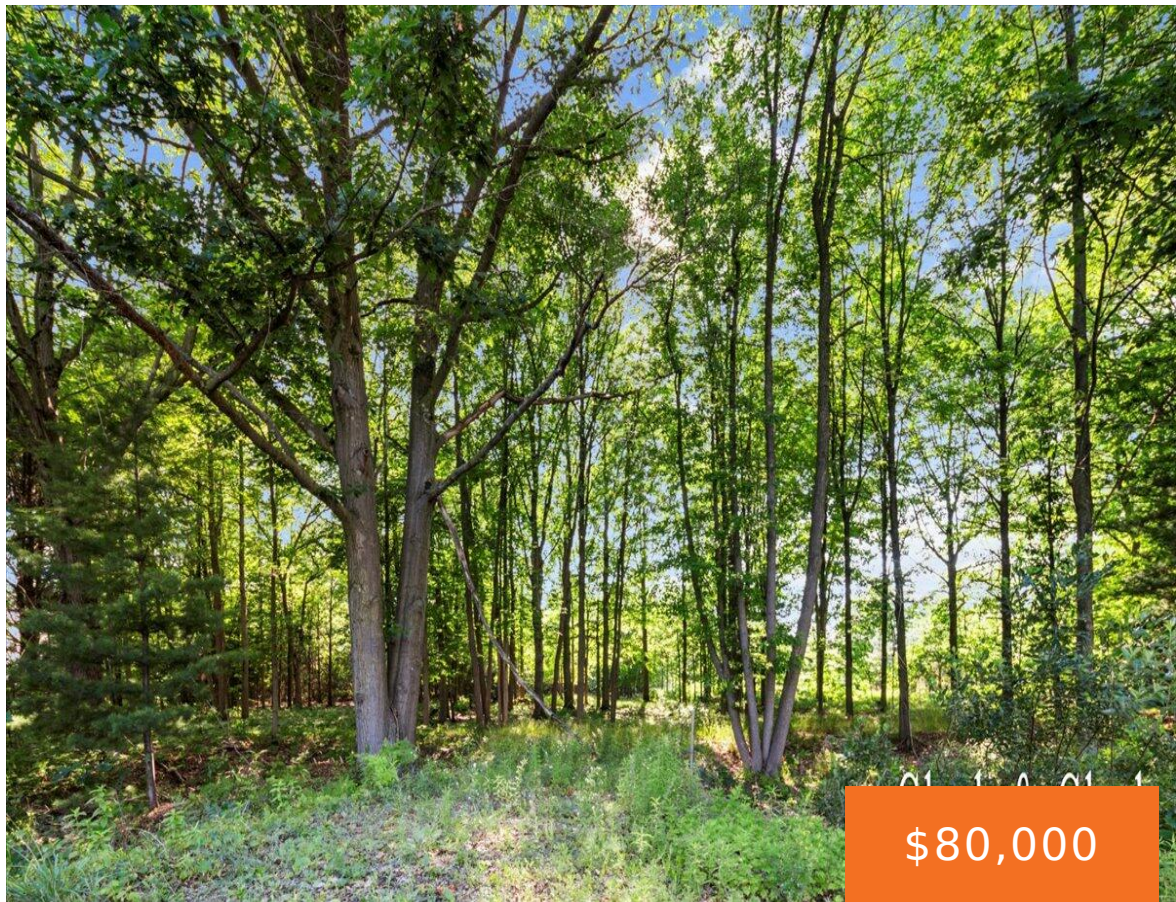

Escape to serenity on this picturesque 2.27-acre wooded lot in Spring Lake Township. Enjoy the perfect blend of seclusion and convenience, with easy access to shopping, restaurants, schools, and the beautiful beaches of Lake Michigan. The lot features a completed culvert and small gravel drive for hassle-free entry. Schedule your showing today!

- 0 baths
- Lot
- Land
- Active



# Basics

**Category:** Land

**Status:** Active

**Lot size:** 2.27 sq ft

**County:** Ottawa

**Type:** Lot

**Bathrooms:** 0 baths

**Lot Size Acres:** 2.27 acres

# Building Details

**Current Use:** Residential

# Amenities & Features

**Utilities:** Natural Gas Available, Electricity Available, Cable Available, Phone Available, None

**Lot Features:** Buildable, Wetland Area, Wooded

# Fees & Taxes

**Tax Assessed Value:** \$10,217

**Tax Year:** 2024

**Tax Annual Amount:** \$3,264

# School Information

**High School District:** Spring Lake

**HighSchool:** Spring Lake High School

**Middle Or Junior School:** Spring Lake Middle School

**Elementary School:** Spring Lake Intermediate School

# Miscellaneous

Call us now



Phone: (231)730-8781

Email: tuckerbennerteam@gmail.com

Address: 2747 Lakeshore Drive, Twin Lake, MI 49457



**Road Surface Type:** Paved

**CrossStreet:** 168th Ave and Wilson

**Listing Terms:** Cash, Conventional

**Call us now**



Phone: (231)730-8781  
Email: tuckerbennerteam@gmail.com  
Address: 2747 Lakeshore Drive, Twin Lake, MI 49457

