

# 170, CRYSTAL, BENTON HARBOR, MI, 49022

<https://tuckerbenner.com>

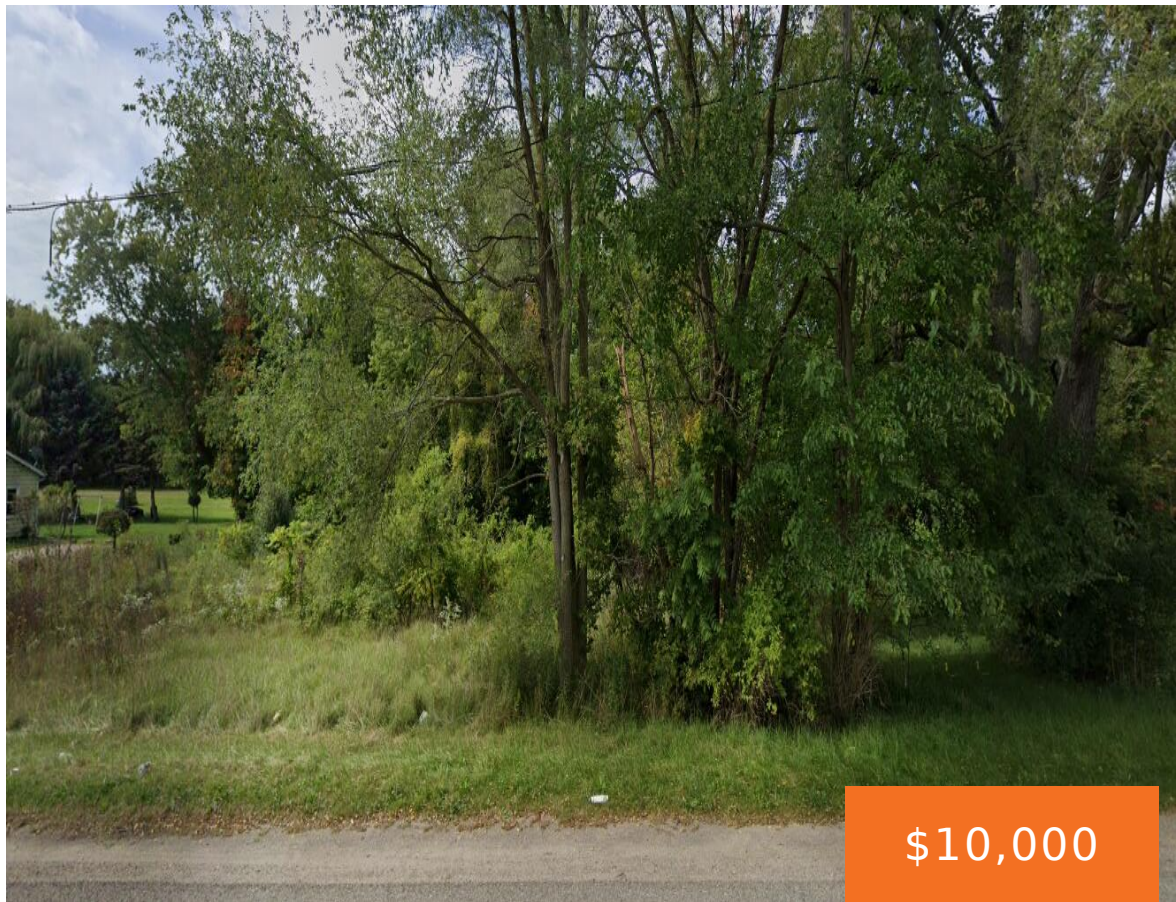

Buildable lot in Benton Harbor Township. Close to City limits and easy access to I94.

- 0 baths
- Lot
- Land
- Active

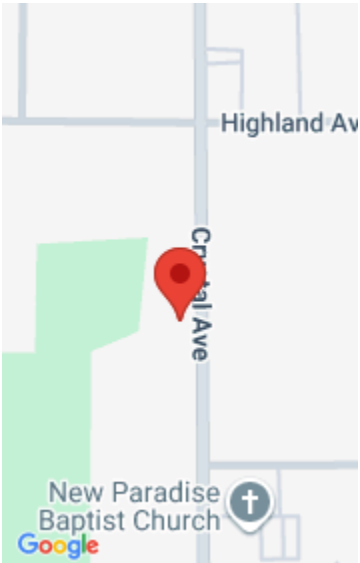

## Basics

**Category:** Land  
**Status:** Active  
**Lot size:** 0.5 sq ft  
**County:** Berrien

**Type:** Lot  
**Bathrooms:** 0 baths  
**Lot Size Acres:** 0.5 acres

## Amenities & Features

**Utilities:** Natural Gas Available, Electricity Available, Cable Available, Phone Available, None

## Fees & Taxes

**Tax Assessed Value:** \$1,400

**Tax Annual Amount:** \$95.43

**Tax Year:** 2024

## School Information

**High School District:** Benton Harbor

## Miscellaneous

**CrossStreet:** Highland Ave & E Britan Ave

**Listing Terms:** Cash, Conventional

### Call us now



Phone: (231)730-8781

Email: tuckerbennerteam@gmail.com

Address: 2747 Lakeshore Drive, Twin Lake, MI 49457

