

# 1720, BRIDGEWATER, YPSILANTI, MI, 48198

https://tuckerbenner.com

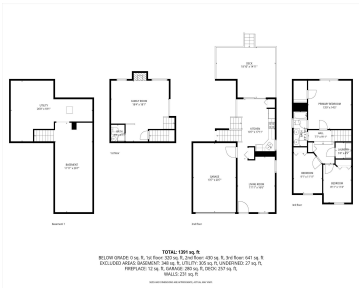

Don't miss this well-maintained contemporary quad-level in the popular Brookside of Superior Township neighborhood, offering a move-in-ready home with plenty of opportunity to add your own updates and build equity over time! The bright main level features a vaulted ceiling and durable, easy-care vinyl plank flooring. A spacious living room welcomes you at the front [...]

- 3 beds
- 2 baths
- Single Family Residence
- Residential
- Active
- 1554 sq ft

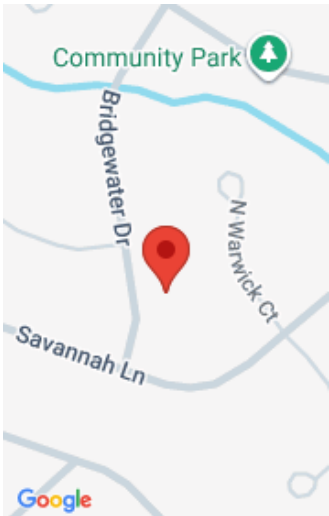

Call us now



Phone: (231)730-8781

Email: tuckerbennerteam@gmail.com

Address: 2747 Lakeshore Drive, Twin Lake, MI 49457



# Basics

**Category:** Residential  
**Status:** Active  
**Bathrooms:** 2 baths  
**Lot size:** 0.18 sq ft  
**Subdivision Name:** Brookside of Superior Township  
**Lot Size Acres:** 0.18 acres  
**County:** Washtenaw

**Type:** Single Family Residence  
**Bedrooms:** 3 beds  
**Area:** 1554 sq ft  
**Year built:** 2003  
**Bathrooms Full:** 1  
**Rooms Total:** 10  
**Bathrooms Half:** 1

# Building Details

**Building Area Total:** 1554 sq ft  
**Architectural Style:** Contemporary  
**Heating:** Forced Air  
**Roof:** Composition, Shingle  
**Basement:** Partial

**Construction Materials:** HardiPlank Type  
**Sewer:** Public  
**Stories:** 2  
**Levels:** Quad-Level

# Amenities & Features

**Laundry Features:** Laundry Room, Upper Level  
**Utilities:** Natural Gas Connected, Cable Connected, Storm Sewer  
**Parking Features:** Garage Faces Front, Garage Door Opener, Attached  
**Garage Spaces:** 2  
**Appliances:** Dishwasher, Dryer, Oven, Range, Refrigerator, Washer  
**Lot Features:** Sidewalk  
**Patio And Porch Features:** Deck  
**Cooling:** Central Air

**Flooring:** Carpet, Vinyl  
**Association Amenities:** Pets Allowed  
**Fireplace Features:** Family Room, Gas Log  
**WaterSource:** Public  
**Interior Features:** Garage Door Opener, Eat-in Kitchen, Pantry  
**Window Features:** Skylight(s), Screens, Insulated Windows  
**Fireplaces Total:** 1

Call us now

---

# Fees & Taxes

**Tax Assessed Value:** \$77,513

**Association Fee:** \$208

**Tax Annual Amount:** \$3,234.69

**Association Fee Frequency:** Semi-Annually

**Tax Year:** 2025

**Association Fee Includes:** Other, Snow Removal

---

# School Information

**High School District:** Ypsilanti

---

# Miscellaneous

**Road Surface Type:** Paved

**CrossStreet:** Geddes and Brookside

**Listing Terms:** Cash, FHA, VA Loan, Conventional

**Call us now**