

18195, 148TH, SPRING LAKE, MI, 49456

<https://tuckerbenner.com>

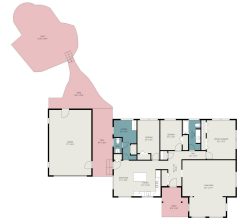

Welcome to 18195 148th Avenue; where peaceful living meets the convenience of being just minutes from everything Spring Lake has to offer. Nestled on an acre of beautifully wooded property, this one-of-a-kind ranch offers the privacy and tranquility you've been searching for while sitting just over a mile from Spring Lake and the Fruitport Boat [...]

- 3 beds
- 2 baths
- Single Family Residence
- Residential
- Active
- 1596 sq ft



Basics

Call us now



Phone: (231)730-8781
Email: tuckerbennerteam@gmail.com
Address: 2747 Lakeshore Drive, Twin Lake, MI 49457



Category: Residential

Status: Active

Bathrooms: 2 baths

Lot size: 1.01 sq ft

Bathrooms Full: 1

Rooms Total: 8

Bathrooms Half: 1

Type: Single Family Residence

Bedrooms: 3 beds

Area: 1596 sq ft

Year built: 1957

Lot Size Acres: 1.01 acres

County: Ottawa

Building Details

Building Area Total: 1596 sq ft

Architectural Style: Ranch

Heating: Forced Air

Roof: Composition

Construction Materials: Wood Siding

Sewer: Septic Tank

Stories: 1

Basement: Crawl Space

Amenities & Features

Laundry Features: Main Level

Parking Features: Detached

WaterSource: Well

Interior Features: Center Island, Eat-in Kitchen

Window Features: Replacement

Cooling: Central Air

Flooring: Carpet, Laminate

Garage Spaces: 1

Appliances: Dishwasher, Range, Refrigerator

Lot Features: Corner Lot, Level, Wooded

Patio And Porch Features: Patio

Fees & Taxes

Tax Assessed Value: \$87,084

Tax Annual Amount: \$2,515.26

Tax Year: 2025

Call us now



Phone: (231)730-8781

Email: tuckerbennerteam@gmail.com

Address: 2747 Lakeshore Drive, Twin Lake, MI 49457



School Information

High School District: Fruitport

Miscellaneous

Road Surface Type: Paved

CrossStreet: 148th Ave & Kelly St

Listing Terms: Cash, FHA, VA Loan, Conventional, Assumable

Call us now



Phone: (231)730-8781

Email: tuckerbennerteam@gmail.com

Address: 2747 Lakeshore Drive, Twin Lake, MI 49457

