

1837, 200TH, HESPERIA, MI, 49421

<https://tuckerbenner.com>

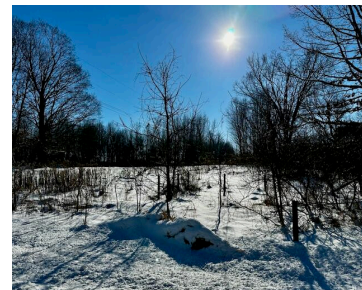
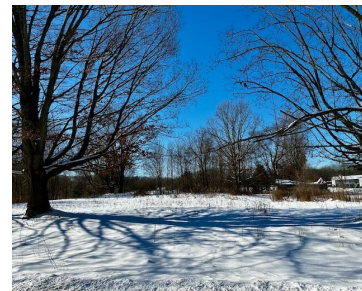
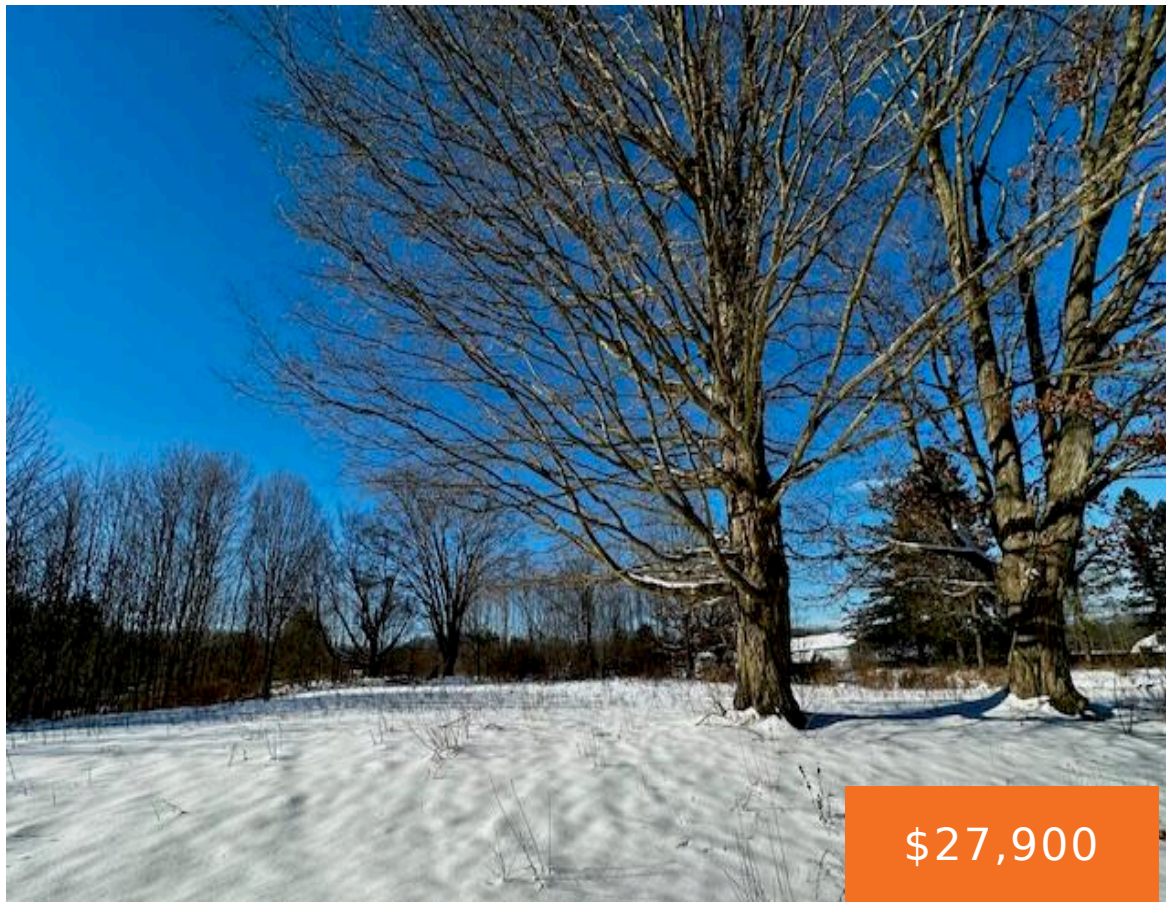

Beautiful building site northwest of Hesperia. Former McLaren Lake Schoolhouse site. 1 acre corner parcel, only minutes away from Hesperia and the McLaren Lake boat launch. Old well & septic on the property, in as-is condition.

- 0 baths
- Lot
- Land
- Active



Basics

Category: Land

Status: Active

Lot size: 1 sq ft

County: Oceana

Type: Lot

Bathrooms: 0 baths

Lot Size Acres: 1 acres



Call us now

Phone: (231)730-8781

Email: tuckerbennerteam@gmail.com

Address: 2747 Lakeshore Drive, Twin Lake, MI 49457



Building Details

Current Use: Residential

Amenities & Features

Utilities: Well, Septic

Lot Features: Corner Lot

Fees & Taxes

Tax Assessed Value: \$3,087

Tax Year: 2022

Tax Annual Amount: \$150

School Information

High School District: Hesperia

Miscellaneous

Road Surface Type: Paved

CrossStreet: Yonker

Listing Terms: Cash, Conventional



Call us now

Phone: (231)730-8781

Email: tuckerbennerteam@gmail.com

Address: 2747 Lakeshore Drive, Twin Lake, MI 49457

