

1917, STIRLING, LANSING, MI, 48910

<https://tuckerbenner.com>

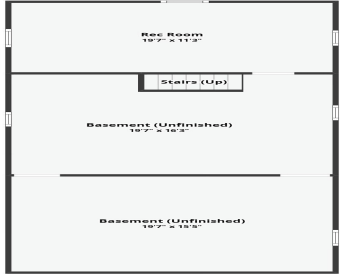

\$114,000

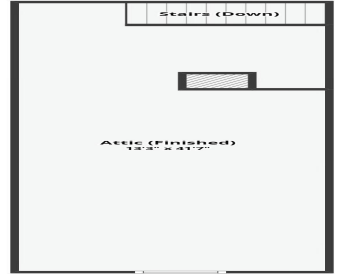
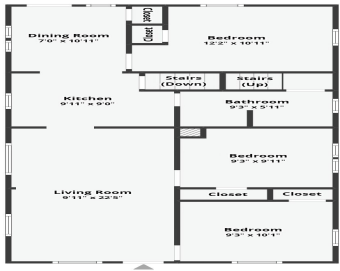

Step into this cozy 3-bedroom, 1-bath ranch-style home featuring beautiful wood floors, lots of windows throughout, a versatile flex room upstairs, and a fenced in back yard with shed. The basement offers abundant space for storage, making it easy to stay organized. Conveniently located and full of potential, this home is ready to make your [...]

- 3 beds
- 1 bath
- Single Family Residence
- Residential
- Active
- 1205 sq ft



Basics



Call us now

Phone: (231)730-8781
 Email: tuckerbennerteam@gmail.com
 Address: 2747 Lakeshore Drive, Twin Lake, MI 49457



Category: Residential

Status: Active

Bathrooms: 1 bath

Lot size: 0.09 sq ft

Bathrooms Full: 1

Rooms Total: 7

Type: Single Family Residence

Bedrooms: 3 beds

Area: 1205 sq ft

Year built: 1923

Lot Size Acres: 0.09 acres

County: Ingham

Building Details

Building Area Total: 1005 sq ft

Architectural Style: Bungalow

Heating: Forced Air

Basement: Michigan Basement, Partial

Construction Materials: Vinyl Siding

Sewer: Public Sewer

Stories: 1

Amenities & Features

Laundry Features: In Basement

Appliances: Washer, Refrigerator, Range, Oven

Lot Features: Sidewalk

WaterSource: Public

Interior Features: Laminate Floor, Wood Floor, Eat-in Kitchen

Exterior Features: Fenced Back

Fees & Taxes

Tax Assessed Value: \$31,808

Tax Annual Amount: \$2,004.38

Tax Year: 2024

School Information

High School District: Lansing



Call us now

Phone: (231)730-8781

Email: tuckerbennerteam@gmail.com

Address: 2747 Lakeshore Drive, Twin Lake, MI 49457



Miscellaneous

CrossStreet: W Mt Hope Ave and Stirling **Listing Terms:** Cash, FHA, VA Loan, MSHDA, Conventional



Call us now

Phone: (231)730-8781

Email: tuckerbennerteam@gmail.com

Address: 2747 Lakeshore Drive, Twin Lake, MI 49457

