

19257, MAYBURY MEADOW, NORTHVILLE, MI, 48167

<https://tuckerbenner.com>

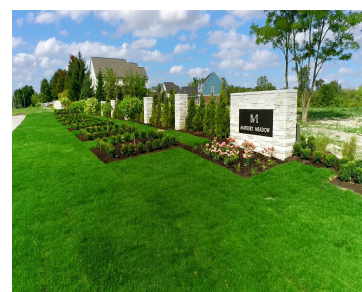
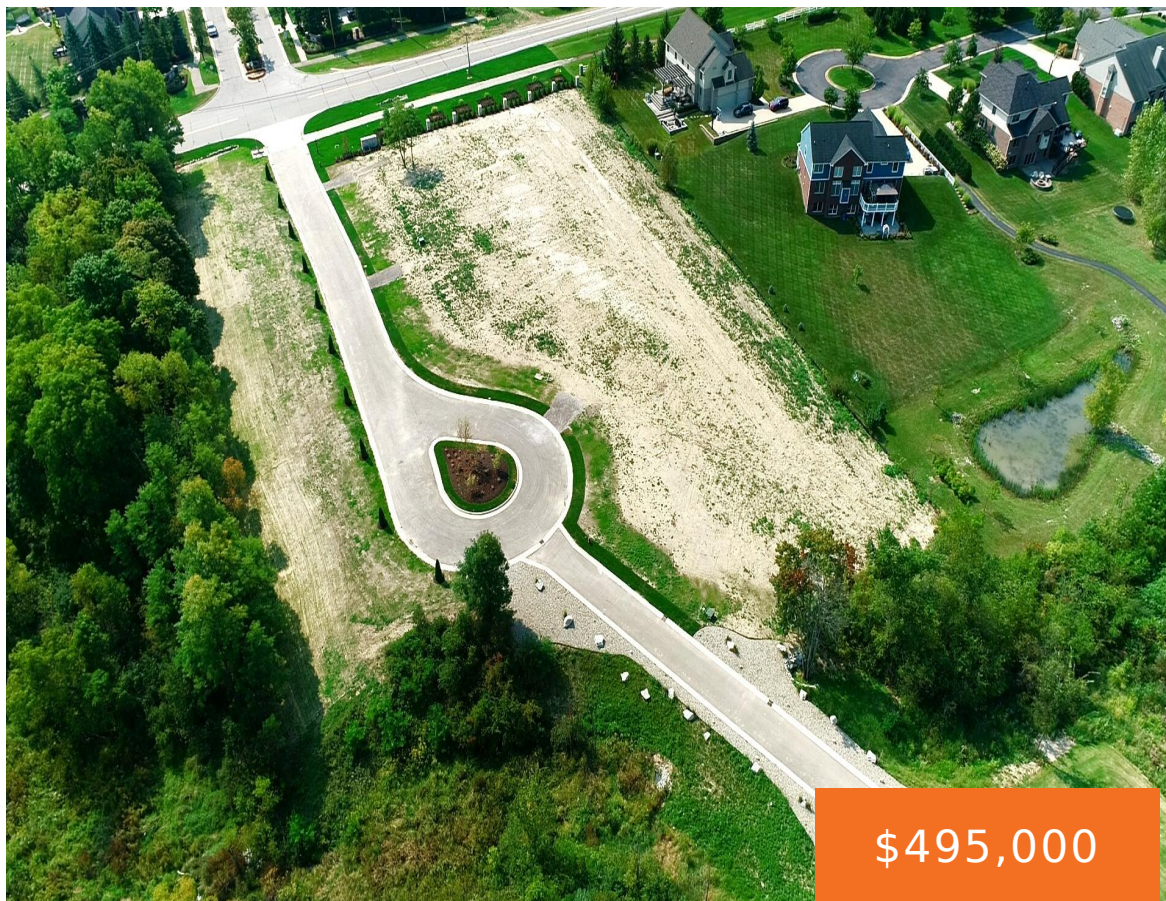

The BENEFIT of this property... amazing details to follow... STAY TUNED

- 0 baths
- Lot
- Land
- Active



## Basics

**Category:** Land

**Status:** Active

**Lot size:** 0.54 sq ft

**Lot Size Acres:** 0.54 acres

**Type:** Lot

**Bathrooms:** 0 baths

**Subdivision Name:** Maybury Meadow

**County:** Wayne



### Call us now

Phone: (231)730-8781

Email: [tuckerbennerteam@gmail.com](mailto:tuckerbennerteam@gmail.com)

Address: 2747 Lakeshore Drive, Twin Lake, MI 49457



---

## Building Details

**Current Use:** Residential

---

## Amenities & Features

**Utilities:** Phone Available, Storm Sewer, Water Available, Sewer Available, Natural Gas Available, Electricity Available, Cable Available, Broadband, Phone Connected, Water Connected, Sewer Connected, Natural Gas Connected, Electricity Connected

**Waterfront Features:** Stream/Creek

**Association Amenities:** Pets Allowed, Other

**Lot Features:** Level, Ravine, Buildable, Cleared, Cul-De-Sac

---

## Fees & Taxes

**Tax Assessed Value:** \$142,500

**Association Fee:** \$2,000

**Tax Annual Amount:** \$1,082

**Association Fee Frequency:** Annually

**Tax Year:** 2024

**Association Fee Includes:** Other

---

## School Information

**High School District:** Northville

**Middle Or Junior School:** Hillside Middle School

**HighSchool:** Northville High School

**Elementary School:** Moraine Elementary School

---

## Miscellaneous

**Road Surface Type:** Paved

**Attribution Contact:** Info@Brandt-RealEstate.com

**CrossStreet:** 7 Mile Road / Napier Road

**Listing Terms:** Cash, Build to Suit, Conventional, Contract



### Call us now

Phone: (231)730-8781

Email: tuckerbennerteam@gmail.com

Address: 2747 Lakeshore Drive, Twin Lake, MI 49457

