

<https://tuckerbenner.com>

<https://tuckerbenner.com>

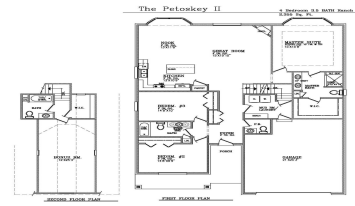

## NEWBURGH ROAD STANDARD FEATURES

### External Features

- Premium birch and/or four sides with no-reinforcement vinyl siding; painted wood trim, eaveboards, and fascia
- Concrete driveway and seppurgh, gershwy, rathony to porch
- Dimensional shingles with vinyl manufacture warranty
- This panel insulated fiberglass entry doors with rubber weather stripping and glass sidelights (depending on availability) on the front door (front entry door & sidelights)
- Each door must be aluminum
- Premium vinyl single-hung windows with Low E & Argon filled glass
- In white color
- Two front-free home feds
- Two front-free electrical outlets
- Aluminum gutter and downspouts
- Prepared for garage door opener
- 16-pd steel roll-up garage door

## Modern Interiors

- \* Direct wired smoke and carbon monoxide detectors with battery backup
- \* Luxury Vinyl flooring in Foyer, connecting Hallways, Powder Room, Kitchen, Nook, & Great Room and Laundry Room **Full Room**
- \* Cluster of six-panel, two-panel square OIL arch-top interior doors
- \* Kitchen: 3" thick and 2 1/2" deep
- \* ~~Shower in 3/4 bathroom~~ painting package (one color flat paint for walls and ceilings)
- \* Full basement with 7'10" poured basement wall height with sump pump
- \* No-maintenance laminate vinyl flooring in all closets
- \* Laundry room with utility sink (Utility Sink varies per model)

PAGE 1 OF 3

## NEWBURGH ROAD STANDARD FEATURES

[Modern Interiors, continued](#)

- a. Gas connection for dryer and range
- b. Door chimes
- c. Builder's lighting package in choice of oil rubbed bronze or brushed nickel finishes
- d. Carpeting carpeting in choice of colors with 6H, padding
- e. Choice of oil rubbed bronze or satin nickel interior door hardware

**Glossary: Nucleons**

- Choice of 30" high cabinetry with choice of finishes (upgraded white or grey shaker-style cabinets included in standard selections)
- Large single or double bowl stainless steel kitchen sink
- Water line for refrigerator
- Single lever faucet with pull-out sprayer in chrome finish
- Luxury Vinyl Plank flooring in Kitchen and Nook in choice of colors
- Garbage disposal
- Granite countertops in kitchen with stainless steel undermount sink
- Gas connection for range

**Handful Maths**  
 0-8176-8447-0, 48 pp, \$12.95

- Black vanity cabinets with choice of finishes (from builder's standard color selections)
- Fiberglass bathtub with tile surround and/or Fiberglass shower unit in master bathroom (bathrooms layout varies per model & floor plan)
- Fiberglass tub/shower unit in main bathroom
- Anti-skid shower and tub controls in chrome finish
- Chrome single handle faucets
- Decorative pedestal sink in powder room
- Full width mirror (wall mirror in powder room)
- Whitewall Laminate Counter Tops

PAGE 2 OF 3

- 4 beds
- 4 baths
- Single Family Residence
- Residential
- Active
- 2355 sq ft

- 4 baths

- Single Family Residence

- Residential

- Active

- 2355 sq ft

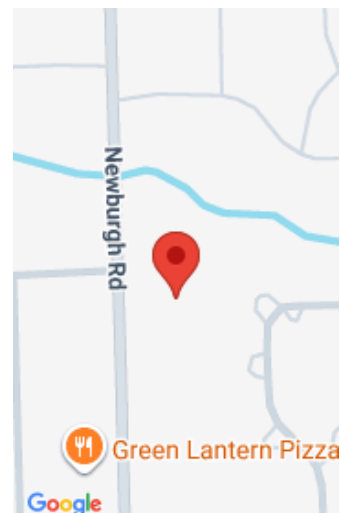

### Green Lantern-Pizza



**Call us now**

Phone: (231)730-8781

Email: [tuckerbennerteam@gmail.com](mailto:tuckerbennerteam@gmail.com)

Address: 2747 Lakeshore Drive, Twin Lake, MI 49457

# Basics

**Category:** Residential

**Status:** Active

**Bathrooms:** 4 baths

**Lot size:** 0.28 sq ft

**Bathrooms Full:** 3

**Rooms Total:** 12

**Bathrooms Half:** 1

**Type:** Single Family Residence

**Bedrooms:** 4 beds

**Area:** 2355 sq ft

**Year built:** 2025

**Lot Size Acres:** 0.28 acres

**County:** Wayne

# Building Details

**Building Area Total:** 2355 sq ft

**Architectural Style:** Cape Cod, Ranch

**Heating:** Forced Air

**Roof:** Asphalt

**Construction Materials:** Brick, Vinyl Siding, Wood Siding

**Sewer:** Public

**Stories:** 2

**Basement:** Daylight, Full

# Amenities & Features

**Laundry Features:** Gas Dryer Hookup, Main Level, Washer Hookup

**Fireplace Features:** Gas Log, Living Room

**WaterSource:** Public

**Window Features:** Bay/Bow

**Fireplaces Total:** 1

**Parking Features:** Garage Faces Front, Attached

**Garage Spaces:** 2

**Interior Features:** Center Island, Pantry

**Patio And Porch Features:** Covered, Porch(es)

**Cooling:** Central Air

# Fees & Taxes

**Tax Year:** 2025

Call us now

---

# School Information

**High School District:** Livonia

---

# Miscellaneous

**Road Surface Type:** Paved **CrossStreet:** 7 Mile and Newburgh Road

**Listing Terms:** Cash, VA Loan, Conventional

**Call us now**