

# 19916, US 12, WHITE PIGEON, MI, 49099

<https://tuckerbenner.com>

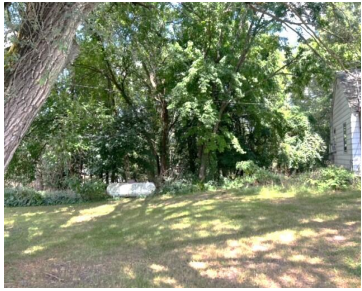

Two bedroom home on over a half acre between Sturgis and White Pigeon. Great opportunity for the new owner to update and make it their own. Great parking, newer well and newer water heater.

- 2 beds
- 1 bath
- Single Family Residence
- Residential
- Active
- 450 sq ft



## Basics



### Call us now

Phone: (231)730-8781  
Email: [tuckerbennerteam@gmail.com](mailto:tuckerbennerteam@gmail.com)  
Address: 2747 Lakeshore Drive, Twin Lake, MI 49457



**Category:** Residential

**Status:** Active

**Bathrooms:** 1 bath

**Lot size:** 0.57 sq ft

**Bathrooms Full:** 1

**Rooms Total:** 4

**Type:** Single Family Residence

**Bedrooms:** 2 beds

**Area:** 450 sq ft

**Year built:** 1940

**Lot Size Acres:** 0.57 acres

**County:** St. Joseph

---

## Building Details

**Building Area Total:** 450 sq ft **Construction Materials:** Aluminum Siding

**Architectural Style:** Bungalow **Sewer:** Septic Tank

**Heating:** Forced Air

**Stories:** 1

**Basement:** Crawl Space

---

## Amenities & Features

**Laundry Features:** None

**WaterSource:** Well

**Appliances:** Range

---

## Fees & Taxes

**Tax Assessed Value:** \$15,139

**Tax Year:** 2024

**Tax Annual Amount:** \$924

---

## School Information

**High School District:** White Pigeon



### Call us now

Phone: (231)730-8781

Email: tuckerbennerteam@gmail.com

Address: 2747 Lakeshore Drive, Twin Lake, MI 49457



---

## Miscellaneous

**Road Surface Type:** Paved

**CrossStreet:** Wallowa and Grass Lake Lane

**Listing Terms:** Cash



### Call us now

Phone: (231)730-8781

Email: [tuckerbennerteam@gmail.com](mailto:tuckerbennerteam@gmail.com)

Address: 2747 Lakeshore Drive, Twin Lake, MI 49457

