

20209, SUNSET, LIVONIA, MI, 48152

https://tuckerbenner.com

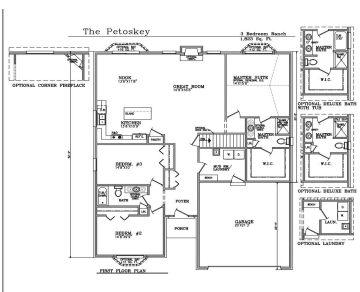

**SUNSET VIEW
STANDARD FEATURES**

Exterior Features

- Premium brick on all four sides with no-maintenance vinyl siding, painted wood trim, overhangs and fascia
- Concrete driveway and apron, paver walkway to porch
- Dimensional shingles with 30-year manufacturer warranty
- No paint needed (except entry doors with rubber weatherstripping and glass sealings (depending on manufacturer)) on the front door (front entry door & side-light) versus per project & observation
- Premium vinyl single-hung windows with Low E & Argon filled glass
- Two front door knobs
- Five weatherproofed electrical outlets
- Aluminum gutters and downspouts
- Prepared for garage door opener
- In-ground leveling garage door
- Concrete driveway

Modern Interiors

- Hardwired smoke and carbon monoxide detectors with battery back-up
- Luxury Vinyl Flooring in Entry, connecting Hallways, Powder Room, Kitchen, Nook, Great Room and Laundry Room/Bed Room
- Choice of 60 paint, two paint options OR scratch interior doors
- Free package: 37' base and 3' 10" casing
- Sherwin Williams painting package (one color flat paint for walls and ceilings)
- Full basement with 1" EPS poured concrete wall height with sump pump
- No maintenance laminate wired shelving in all closets
- Laundry room with utility sink (utility sink extra per model)
- Prepared for dryer vent and rear washer drain box in laundry room

PAGE 1 OF 3

Discover your dream home in Livonia! This stunning new construction ranch, completion Fall/Winter, offers 1,823 sq ft of modern elegance. 3 bedrooms & 2 baths, this home boasts an upgraded elevation w/ a spacious front porch. Inside, enjoy 9ft first-floor ceilings & a deluxe primary suite w/ a deluxe bath w/ granite counters, dual vanity, [...]

- 3 beds
- 2 baths
- Single Family Residence
- Residential
- Active
- 1823 sq ft

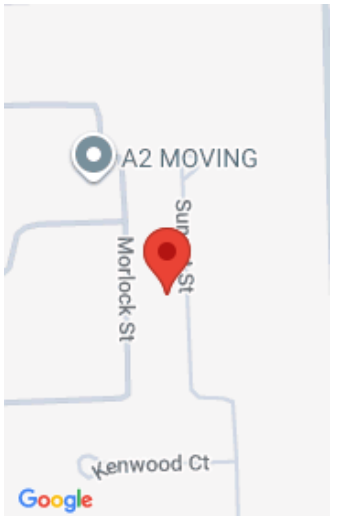

Call us now

Phone: (231)730-8781

Email: tuckerbennerteam@gmail.com

Address: 2747 Lakeshore Drive, Twin Lake, MI 49457

Basics

Category: Residential

Status: Active

Bathrooms: 2 baths

Lot size: 0.25 sq ft

Subdivision Name: Sunset View

Lot Size Acres: 0.25 acres

County: Wayne

Type: Single Family Residence

Bedrooms: 3 beds

Area: 1823 sq ft

Year built: 2025

Bathrooms Full: 2

Rooms Total: 9

Building Details

Building Area Total: 1823 sq ft

Architectural Style: Ranch

Heating: Forced Air

Roof: Asphalt

Construction Materials: Brick, Vinyl Siding

Sewer: Public

Stories: 1

Basement: Full

Amenities & Features

Laundry Features: Gas Dryer Hookup, Main Level, Washer Hookup

Parking Features: Garage Faces Front, Attached

Garage Spaces: 2

Interior Features: Center Island

Patio And Porch Features: Porch(es)

Flooring: Carpet, Vinyl

Fireplace Features: Gas Log, Living Room

WaterSource: Public

Window Features: Insulated Windows

Fireplaces Total: 1

Fees & Taxes

Association Fee Frequency: Annually

Association Fee: \$350

Call us now

School Information

High School District: Clarenceville

Miscellaneous

Road Surface Type: Paved

CrossStreet: 8 mile & Merriman

Listing Terms: Cash, FHA, VA Loan, Conventional

Call us now



Phone: (231)730-8781
Email: tuckerbennerteam@gmail.com
Address: 2747 Lakeshore Drive, Twin Lake, MI 49457

