

21249, MONROE, MORLEY, MI, 49336

<https://tuckerbenner.com>

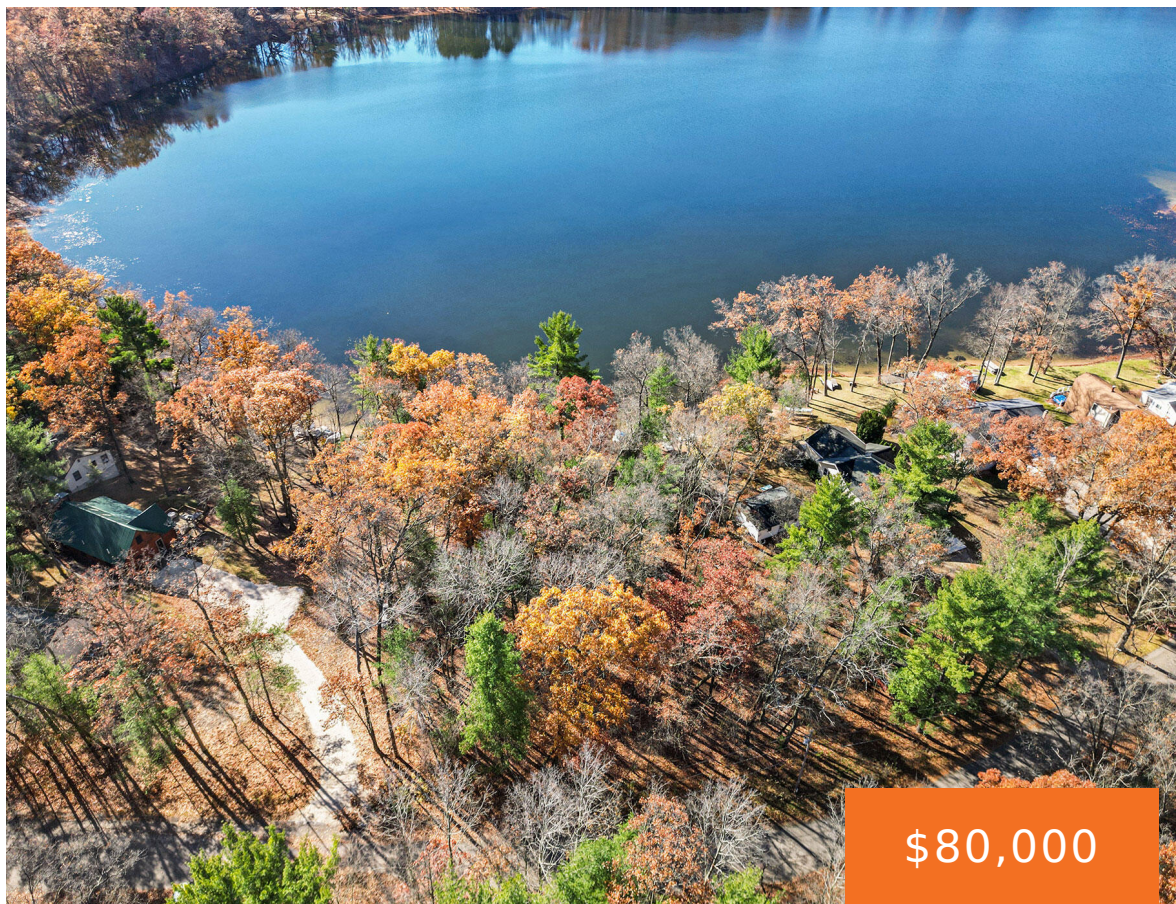

What a great opportunity! Discover this lakefront property on private Brady Lake in Mecosta County. This .319-acre lot boasts approximately 80 feet of scenic shoreline and is conveniently situated just 35 minutes from Grand Rapids. With a gentle slope to the water and partially cleared areas, it's a perfect canvas for your dream home. Enjoy [...]

- 0 baths
- Lot
- Land
- Active



Call us now

Phone: (231)730-8781
Email: tuckerbennerteam@gmail.com
Address: 2747 Lakeshore Drive, Twin Lake, MI 49457

Basics

Category: Land

Status: Active

Lot size: 0.32 sq ft

County: Mecosta

Type: Lot

Bathrooms: 0 baths

Lot Size Acres: 0.32 acres

Amenities & Features

Utilities: None

Waterfront Features: Lake

Lot Features: Buildable, Cul-De-Sac, Wooded

Fees & Taxes

Tax Assessed Value: \$19,740

Tax Year: 2022

Tax Annual Amount: \$878.87

School Information

High School District: Morley Stanwood

Miscellaneous

CrossStreet: Brady Dr

Listing Terms: Cash, Conventional

Call us now



Phone: (231)730-8781

Email: tuckerbennerteam@gmail.com

Address: 2747 Lakeshore Drive, Twin Lake, MI 49457

