

# 228, HIGMAN PARK, BENTON HARBOR, MI, 49022

<https://tuckerbenner.com>

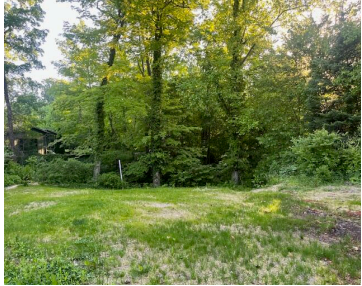

**\$890,000**



Rare opportunity to own and build a house in Higman Park. Phenomenal Lake Michigan views with private beach access. Located in a private culdesac, you can live your best life just step away from sandy beaches, Harbor Shores Golf Club, walking trails and much more. This opportunity should not be missed!

- 0 baths
- Lot
- Land
- Active



## Basics

**Category:** Land

**Status:** Active

**Lot size:** 0.26 sq ft

**County:** Berrien

**Type:** Lot

**Bathrooms:** 0 baths

**Lot Size Acres:** 0.26 acres



### Call us now

Phone: (231)730-8781  
 Email: [tuckerbennerteam@gmail.com](mailto:tuckerbennerteam@gmail.com)  
 Address: 2747 Lakeshore Drive, Twin Lake, MI 49457



---

## Amenities & Features

**Utilities:** None Connected, Public Water Available, Public Sewer Available, Natural Gas Available, Electric Available

**Association Amenities:**  
Beach Area

**Waterfront Features:** Private Frontage

---

## Fees & Taxes

**Association Fee Frequency:** Annually

**Association Fee:** \$100

---

## School Information

**High School District:** Benton Harbor

---

## Miscellaneous

**CrossStreet:** Rocky Gap

**Listing Terms:** Cash, Conventional



### Call us now

Phone: (231)730-8781

Email: [tuckerbennerteam@gmail.com](mailto:tuckerbennerteam@gmail.com)

Address: 2747 Lakeshore Drive, Twin Lake, MI 49457

