

22951, RIVERSIDE, MENDON, MI, 49072

<https://tuckerbenner.com>

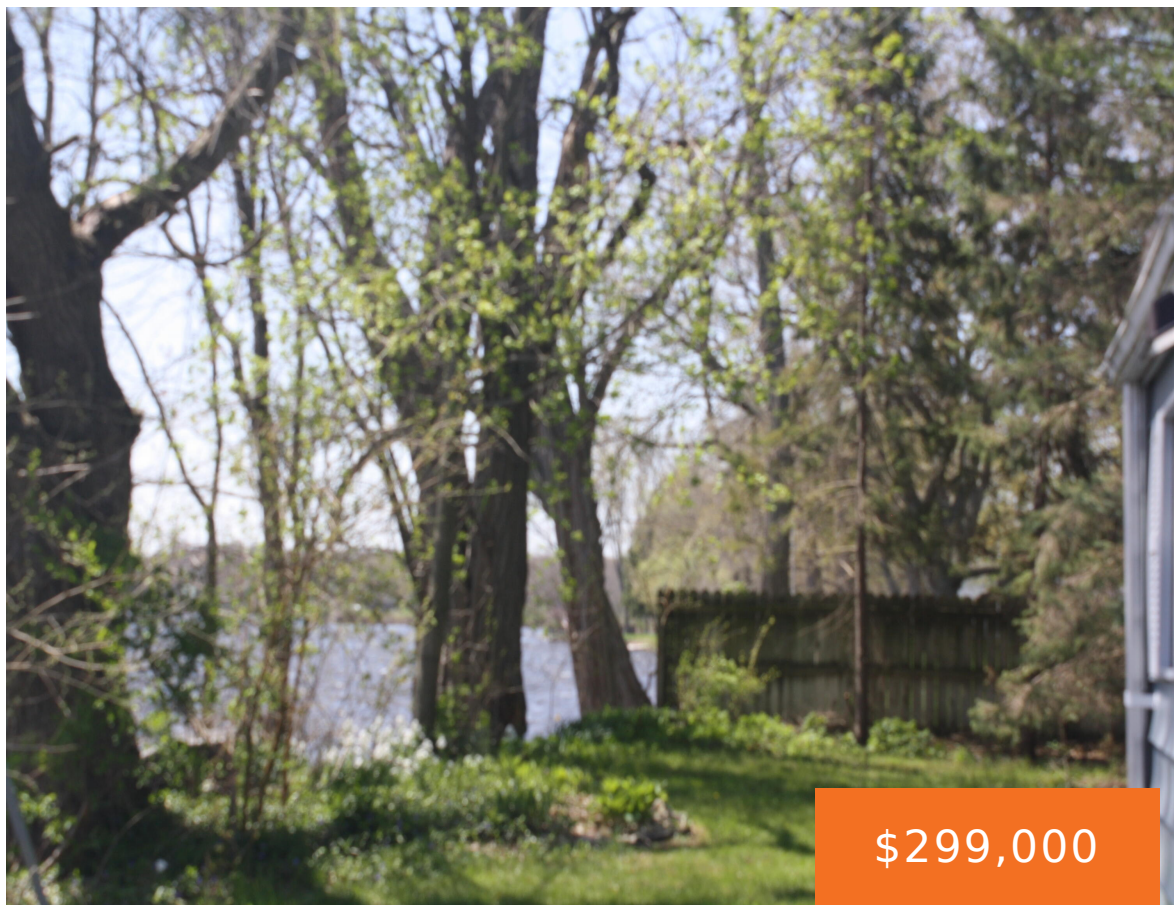

This listing is a complete package. 150 ft. of water frontage with a sandy level beach area. Lot has under ground sprinklers and ample space for off road guest parking. The three car garage provides storage for cars and boat and water toys. There is a storage shed conveniently located near the shore. The home [...]

- 2 beds
- 2 baths
- Single Family Residence
- Residential
- Active
- 2200 sq ft

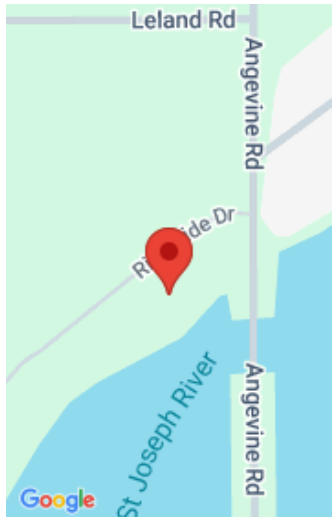

Call us now



Phone: (231)730-8781
Email: tuckerbennerteam@gmail.com
Address: 2747 Lakeshore Drive, Twin Lake, MI 49457



Basics

Category: Residential

Status: Active

Bathrooms: 2 baths

Lot size: 0.53 sq ft

Subdivision Name: Riverview Shores subdivision Sec 6 R10w

Lot Size Acres: 0.53 acres

County: St. Joseph

Type: Single Family Residence

Bedrooms: 2 beds

Area: 2200 sq ft

Year built: 1981

Bathrooms Full: 2

Rooms Total: 10

Building Details

Building Area Total: 2200 sq ft

Architectural Style: Traditional

Heating: Forced Air

Roof: Asphalt, Shingle

Construction Materials: Vinyl Siding

Sewer: Septic Tank

Stories: 2

Basement: Slab

Amenities & Features

Call us now



Phone: (231)730-8781

Email: tuckerbennerteam@gmail.com

Address: 2747 Lakeshore Drive, Twin Lake, MI 49457



Laundry Features: Electric Dryer Hookup, Laundry Room, Main Level, Washer Hookup

Flooring: Carpet, Laminate

Parking Features: Garage Faces Front, Garage Door Opener, Attached

Garage Spaces: 3

Appliances: Microwave, Oven, Range, Refrigerator

Lot Features: Recreational

Patio And Porch Features: Patio

Cooling: Central Air

Electric: Generator

Utilities: Natural Gas Available, Electricity Available, Cable Available, Natural Gas Connected, Cable Connected, High-Speed Internet

Waterfront Features: River

WaterSource: Well

Interior Features: Ceiling Fan(s), Broadband, Garage Door Opener, Pantry

Window Features: Low-Emissivity Windows, Skylight(s), Screens, Replacement, Insulated Windows, Window Treatments

Exterior Features: Balcony

Fees & Taxes

Tax Assessed Value: \$53,437

Tax Year: 2025

Tax Annual Amount: \$2,671.55

School Information

High School District: Centreville

HighSchool: Centreville Jr/Sr High School

Elementary School: Centreville Elementary School

Miscellaneous

Road Surface Type: Paved

CrossStreet: Angevine Rd and end

Listing Terms: Cash, FHA, VA Loan, Rural Development, MSHDA, Conventional

Call us now



Phone: (231)730-8781

Email: tuckerbennerteam@gmail.com

Address: 2747 Lakeshore Drive, Twin Lake, MI 49457

