

2313, WESTNEDGE, KALAMAZOO, MI, 49008
https://tuckerbenner.com

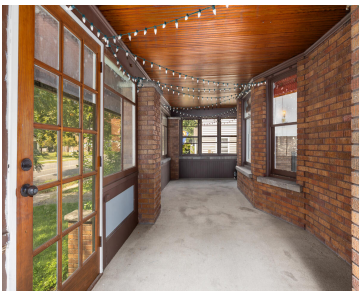

This 4-bedroom, 2-bath Westnedge Hill bungalow offers classic charm with thoughtful updates and a prime location. Built-ins, crown molding, and a sunlit living room with a cozy fireplace create a warm and welcoming atmosphere. The updated kitchen features stainless steel appliances, while recent improvements like a new roof and washer/dryer add move-in-ready convenience. A finished [...]

- 4 beds
- 2 baths
- Single Family Residence
- Residential
- Active
- 2321 sq ft

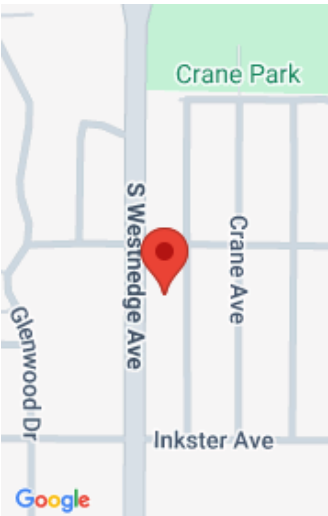

Call us now

Phone: (231)730-8781
Email: tuckerbennerteam@gmail.com
Address: 2747 Lakeshore Drive, Twin Lake, MI 49457

Basics

Category: Residential

Status: Active

Bathrooms: 2 baths

Lot size: 0.14 sq ft

Bathrooms Full: 2

Rooms Total: 9

Type: Single Family Residence

Bedrooms: 4 beds

Area: 2321 sq ft

Year built: 1917

Lot Size Acres: 0.14 acres

County: Kalamazoo

Building Details

Building Area Total: 1806 sq ft

Architectural Style: Traditional

Heating: Radiant

Roof: Composition, Shingle

Construction Materials: Brick

Sewer: Public

Stories: 2

Basement: Full

Amenities & Features

Laundry Features: In Basement

Fireplace Features: Family Room

WaterSource: Public

Window Features: Insulated Windows

Cooling: Window Unit(s)

Parking Features: Detached

Garage Spaces: 1

Appliances: Dishwasher, Dryer, Oven, Refrigerator, Washer

Fireplaces Total: 1

Fees & Taxes

Tax Assessed Value: \$93,434

Tax Annual Amount: \$4,654

Tax Year: 2024

Call us now

 Phone: (231)730-8781

 Email: tuckerbennerteam@gmail.com

 Address: 2747 Lakeshore Drive, Twin Lake, MI 49457



School Information

High School District: Kalamazoo

Miscellaneous

Road Surface Type: Paved

CrossStreet: Parkwood & Inkster

Listing Terms: Cash, Conventional

Call us now