

# 2459, HOLTON, MUSKEGON, MI, 49445

https://tuckerbenner.com

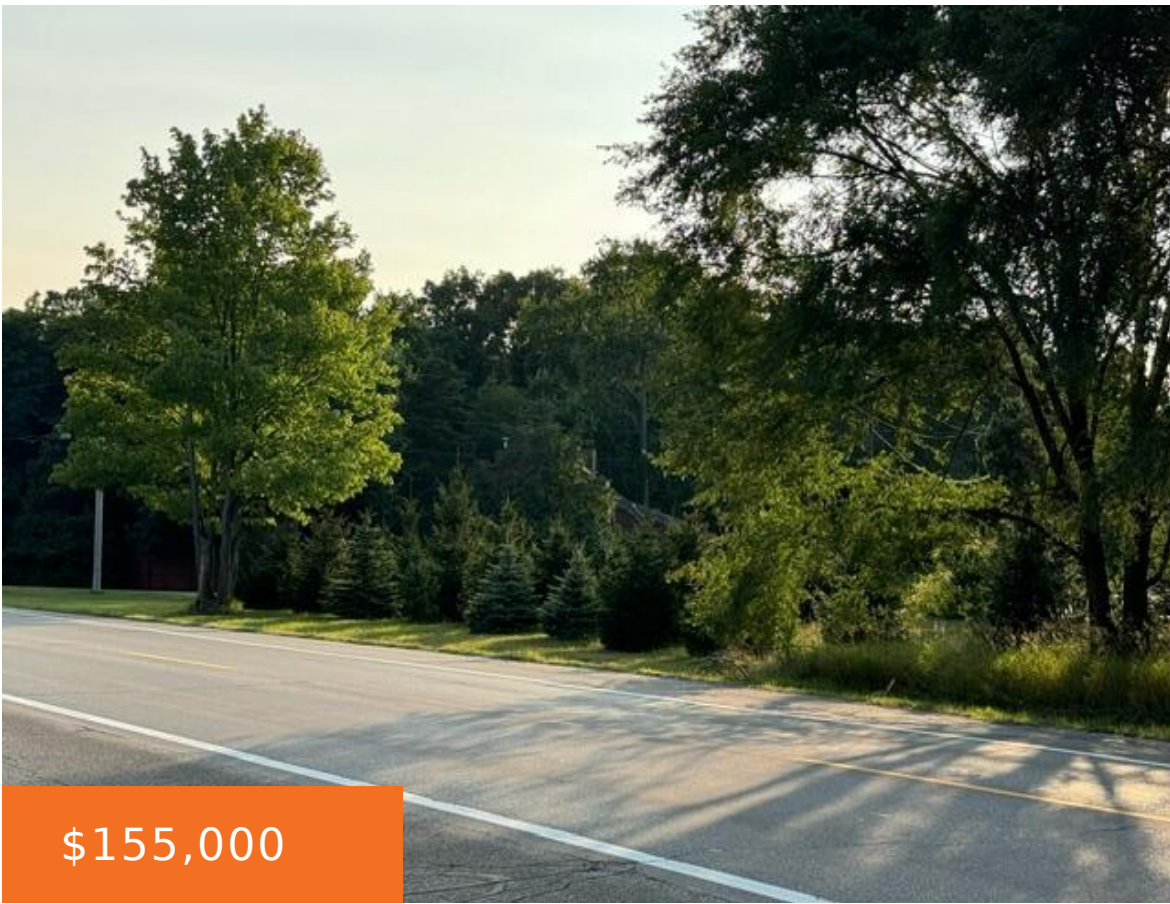

\$155,000

This remarkable 1.45-acre (3 parcels) of vacant land offers the ideal setting for your future home or investment. Situated conveniently close to major roads and just minutes from essential amenities, this property combines the tranquility of open space with the convenience of nearby shopping, dining, and recreational options. Whether you're envisioning a custom-built home, a [...]

- 0 baths
- Acreage
- Land
- Active



## Basics

**Category:** Land

**Status:** Active

**Lot size:** 1.45 sq ft

**County:** Muskegon

**Type:** Acreage

**Bathrooms:** 0 baths

**Lot Size Acres:** 1.45 acres



### Call us now

Phone: (231)730-8781

Email: tuckerbennerteam@gmail.com

Address: 2747 Lakeshore Drive, Twin Lake, MI 49457



---

## Amenities & Features

**Utilities:** Phone Available, Natural Gas Available, Electricity Available, None

**Lot Features:** Level, Buildable, Cleared, Corner Lot

---

## Fees & Taxes

**Tax Assessed Value:** \$400

**Tax Year:** 2023

**Tax Annual Amount:** \$400

---

## School Information

**High School District:** Reeths-Puffer

---

## Miscellaneous

**CrossStreet:** Koonsman

**Listing Terms:** Cash, Conventional



### Call us now

Phone: (231)730-8781

Email: [tuckerbennerteam@gmail.com](mailto:tuckerbennerteam@gmail.com)

Address: 2747 Lakeshore Drive, Twin Lake, MI 49457

