

# 250, PLYMOUTH, EAST GRAND RAPIDS, MI, 49506

<https://tuckerbenner.com>

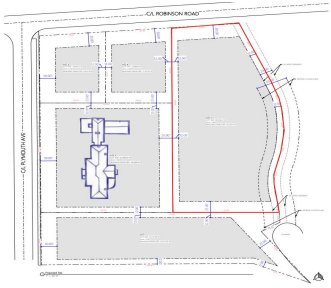

Presenting an exceptional opportunity to build on a scale rarely encountered in East Grand Rapids. Lot 5 at the historic Brookby Estate offers a sprawling 1.85-acre canvas, providing a level of space and seclusion that is remarkably hard to find in the heart of the city. This premium home site is defined by its impressive [...]

- 0 baths
- Lot
- Land
- Active

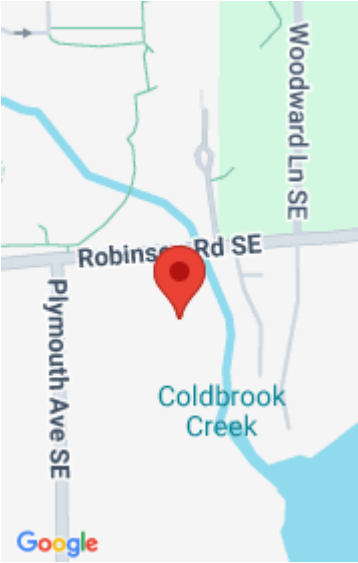

## Call us now

Phone: (231)730-8781  
Email: [tuckerbennerteam@gmail.com](mailto:tuckerbennerteam@gmail.com)  
Address: 2747 Lakeshore Drive, Twin Lake, MI 49457



---

## Basics

**Category:** Land

**Status:** Active

**Lot size:** 1.85 sq ft

**County:** Kent

**Type:** Lot

**Bathrooms:** 0 baths

**Lot Size Acres:** 1.85 acres

---

## Building Details

**Sewer:** Public Sewer

**Current Use:** Residential

---

## Amenities & Features

**Utilities:** Natural Gas Available, Cable Available, None

**WaterSource:** Public

**Waterfront Features:** Stream/Creek

**Lot Features:** Buildable, Sidewalk

---

## Fees & Taxes

**Tax Year:** 2025

---

## School Information

**High School District:** East Grand Rapids

**Elementary School:** Wealthy School

---

## Miscellaneous

**Road Surface Type:** Paved

**CrossStreet:** Plymouth and Robinson

**Listing Terms:** Cash, Build to Suit, Conventional

### Call us now



Phone: (231)730-8781

Email: tuckerbennerteam@gmail.com

Address: 2747 Lakeshore Drive, Twin Lake, MI 49457

