

2530, RIDGEWAY, JACKSON, MI, 49203

<https://tuckerbenner.com>

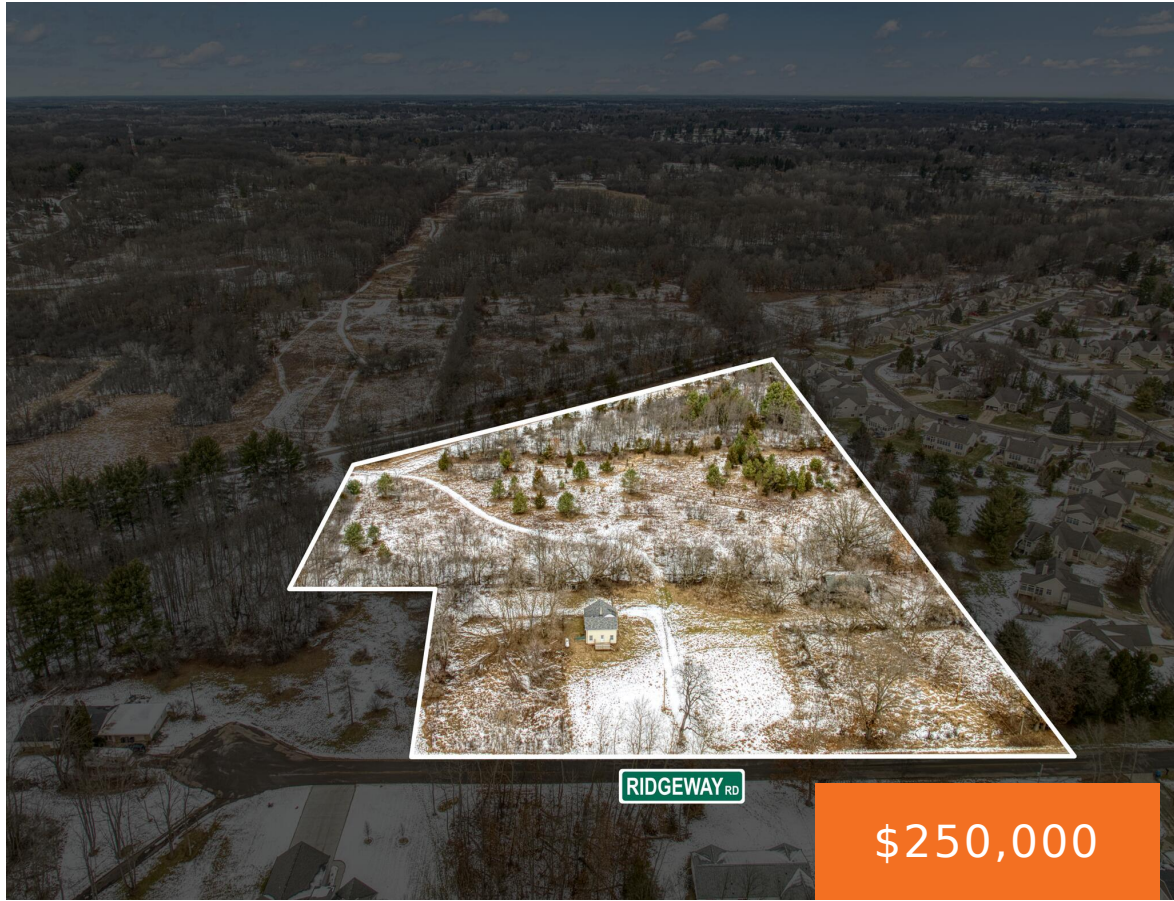

Premium building site for your estate home or buy and create 4 sites for residential development at low cost. 9.43 Acres of rolling terrain located on the southside of the Falling Waters Trail. Convenient Summit Township location only 5 miles from downtown Jackson. Next door to Lakewood Ridge Preserve Condominiums and other fine homes. Water, [...]

- 0 baths
- Lot
- Land
- Active



Basics

Category: Land

Status: Active

Lot size: 9.53 sq ft

County: Jackson

Type: Lot

Bathrooms: 0 baths

Lot Size Acres: 9.53 acres



Call us now

Phone: (231)730-8781

Email: tuckerbennerteam@gmail.com

Address: 2747 Lakeshore Drive, Twin Lake, MI 49457



Building Details

Current Use: Residential

Amenities & Features

Utilities: Water Available, Sewer Available, Water Connected

Lot Features: Building, Cul-De-Sac

Fees & Taxes

Tax Assessed Value: \$56,227

Tax Year: 2024

Tax Annual Amount: \$3,149.09

School Information

High School District: Jackson

Miscellaneous

Road Surface Type: Paved

CrossStreet: Hidden Ridge Trl

Listing Terms: Cash, Conventional



Call us now

Phone: (231)730-8781

Email: tuckerbennerteam@gmail.com

Address: 2747 Lakeshore Drive, Twin Lake, MI 49457

