

27, TIFFANY, EDWARDSBURG, MI, 49112

https://tuckerbenner.com

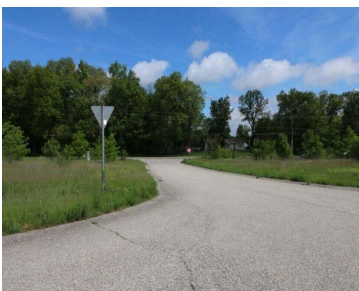

Frontage on small "Lake Sophia" with serene views. Possible usage for paddle board, kayak, or fishing. Buildable lot in Michiana Shores Development. Infrastructure has been laid throughout the development. There is a total of 39 lots, 37 are currently on the market, 1 has existing home, another lot currently under construction.

- 0 baths
- Lot
- Land
- Active



Basics

**Category:** Land  
**Status:** Active  
**Lot size:** 0.33 sq ft  
**County:** Cass

**Type:** Lot  
**Bathrooms:** 0 baths  
**Lot Size Acres:** 0.33 acres



**Call us now**  
Phone: (231)730-8781  
Email: tuckerbennerteam@gmail.com  
Address: 2747 Lakeshore Drive, Twin Lake, MI 49457



---

## Amenities & Features

**Waterfront Features:** No Wake, Private Frontage, Pond

**Lot Features:** Buildable

---

## Fees & Taxes

**Tax Assessed Value:** \$5,257

**Tax Year:** 2022

**Tax Annual Amount:** \$233

---

## School Information

**High School District:** Edwardsburg

---

## Miscellaneous

**CrossStreet:** May St (Ashley)

**Listing Terms:** Cash, Conventional



### Call us now

Phone: (231)730-8781

Email: [tuckerbennerteam@gmail.com](mailto:tuckerbennerteam@gmail.com)

Address: 2747 Lakeshore Drive, Twin Lake, MI 49457

