

274, SHEPHERD, MOUNT PLEASANT, MI, 48858

<https://tuckerbenner.com>

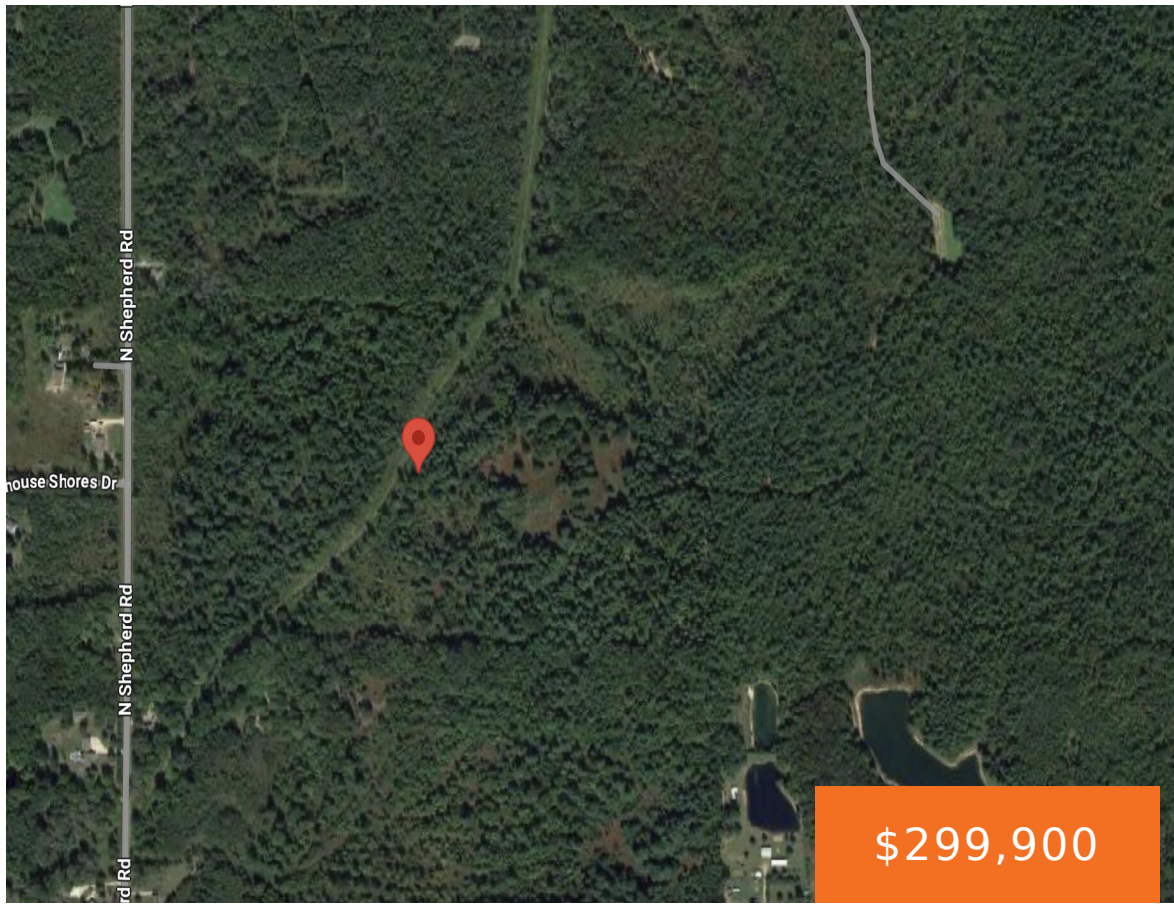

\$299,900

- 0 baths
- Acreage
- Land
- Active



Basics

Category: Land

Type: Acreage

Status: Active

Bathrooms: 0 baths

Lot size: 80.62 sq ft

Lot Size Acres: 80.62 acres

County: Isabella



Call us now

Phone: (231)730-8781
 Email: tuckerbennerteam@gmail.com
 Address: 2747 Lakeshore Drive, Twin Lake, MI 49457



Amenities & Features

Utilities: None

Fees & Taxes

Tax Assessed Value: \$87,354

Tax Year: 2024

Tax Annual Amount: \$1,156.50

School Information

High School District: Mount Pleasant

Miscellaneous

CrossStreet: E Baseline and N Shepherd

Listing Terms: Cash, Conventional



Call us now

Phone: (231)730-8781

Email: tuckerbennerteam@gmail.com

Address: 2747 Lakeshore Drive, Twin Lake, MI 49457

