

29102, TERRENCE, LIVONIA, MI, 48154

https://tuckerbenner.com

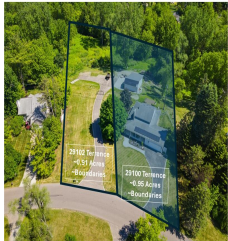

Serene 0.91 acre vacant residential property at 29102 Terrence Street in a classic neighborhood with mature trees and bordering the center line of Bell Creek. Perfect location for a new home construction (eligibility of buildability to be determined by buyer), or can be purchased together with the separate adjacent residential home listing at 29100 Terrence [...]

- 0 baths
- Acreage
- Land
- Active



Basics

Category: Land

Type: Acreage

Status: Active

Bathrooms: 0 baths

Lot size: 0.91 sq ft

Lot Size Acres: 0.91 acres

County: Wayne

Call us now



Phone: (231)730-8781

Email: tuckerbennerteam@gmail.com

Address: 2747 Lakeshore Drive, Twin Lake, MI 49457



Building Details

Sewer: Public Sewer

Current Use: Residential

Amenities & Features

Utilities: Natural Gas Available, Electricity Available, Cable Available, Phone Available, None

WaterSource: Public

Waterfront Features: Stream/Creek

Lot Features: Rolling Hills, Cleared, Wetland Area, Wooded

Fees & Taxes

Tax Assessed Value: \$30,085

Tax Year: 2025

Tax Annual Amount: \$1,787.44

School Information

High School District: Livonia

Miscellaneous

Road Surface Type: Paved

CrossStreet: 6 Mile and Middlebelt

Listing Terms: Cash, FHA, VA Loan, Conventional

Call us now



Phone: (231)730-8781

Email: tuckerbennerteam@gmail.com

Address: 2747 Lakeshore Drive, Twin Lake, MI 49457

