

# 295, BEACHWOOD, DOUGLAS, MI, 49406

https://tuckerbenner.com

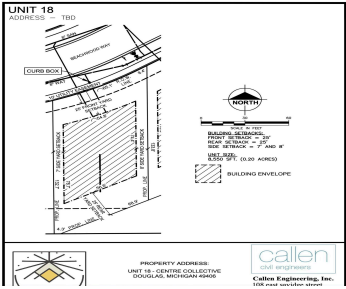

\$275,000



THIS LOT IS RESERVED!! Scandinavian-Inspired Living Near the Shores of Lake Michigan! Rare opportunity to own a homesite in an exclusive 19-lot development just a short walk to the pristine beaches of Lake Michigan. Located in the charming communities of Douglas & Saugatuck, MI, this new development is designed for single-family homes, blending modern simplicity, [...]

- 0 baths
- Lot
- Land
- Active

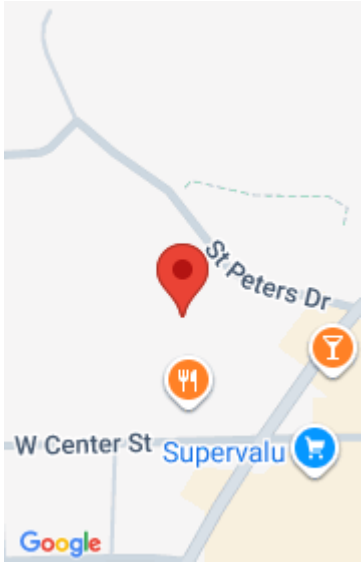

### Call us now

Phone: (231)730-8781  
 Email: tuckerbennerteam@gmail.com  
 Address: 2747 Lakeshore Drive, Twin Lake, MI 49457



---

## Basics

**Category:** Land

**Status:** Active

**Lot size:** 0.2 sq ft

**County:** Allegan

**Type:** Lot

**Bathrooms:** 0 baths

**Lot Size Acres:** 0.2 acres

---

## Building Details

**Sewer:** Public Sewer

**Current Use:** Residential

---

## Amenities & Features

**Utilities:** Natural Gas Available, Electricity Available, Cable Available, Storm Sewer, None

**Waterfront Features:** Pond

**Interior Features:** Broadband

**Association Amenities:** Pets Allowed, Trail(s)

**WaterSource:** Public

**Lot Features:** Level, Site Condo, Buildable, Sidewalk

---

## Fees & Taxes

**Tax Assessed Value:** \$100,000 **Association Fee Frequency:** Monthly

**Association Fee:** \$125 **Tax Year:** 2024

**Tax Annual Amount:** \$2,500 **Association Fee Includes:** Lawn/Yard Care, Trash

---

## School Information

**High School District:** Saugatuck-Douglas

**Middle Or Junior School:** Saugatuck Middle School

**HighSchool:** Saugatuck High School

**Elementary School:** Douglas Elementary School

### Call us now



Phone: (231)730-8781

Email: tuckerbennerteam@gmail.com

Address: 2747 Lakeshore Drive, Twin Lake, MI 49457



---

## Miscellaneous

**CrossStreet:** Blue Star Hwy and Hamilton

**Listing Terms:** Cash, Conventional

### Call us now



Phone: (231)730-8781

Email: [tuckerbennerteam@gmail.com](mailto:tuckerbennerteam@gmail.com)

Address: 2747 Lakeshore Drive, Twin Lake, MI 49457

