

# 3021, SCHOEDEL, MANISTEE, MI, 49660

<https://tuckerbenner.com>

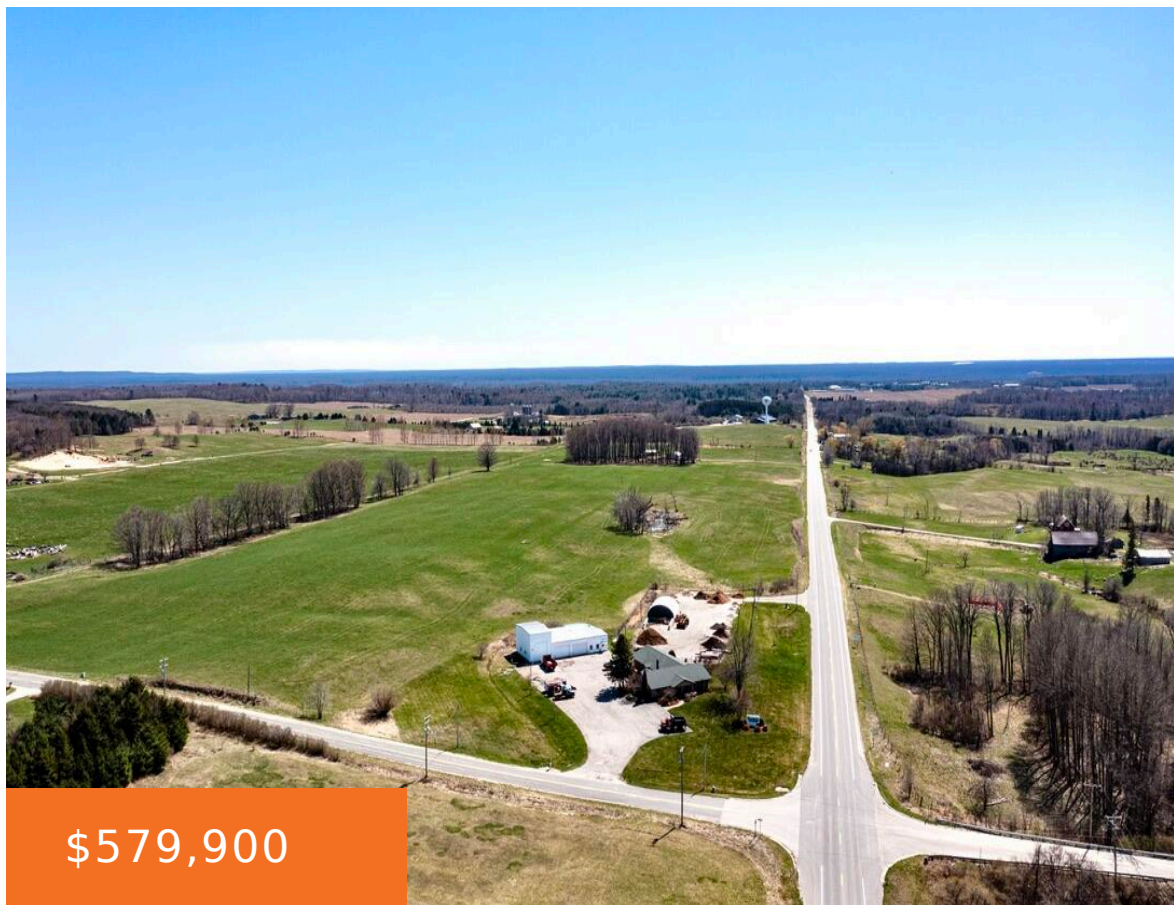

\$579,900

Check out this OUTSTANDING commercial property! Spanning 5 acres, of valuable land that is partially fenced in. The listing includes a commercial garage, and an office building with an attached apartment. With its prime location and endless potential, this property presents an excellent opportunity for investors and entrepreneurs. Schedule your showing today! Buyers/ Buyers Agent [...]

- 2 baths
- Retail/Commercial
- Commercial Sale
- Active



## Basics

**Category:** Commercial Sale

**Status:** Active

**Lot size:** 5 sq ft

**Bathrooms Full:** 2

**Business Type:** Professional/Office, Professional Service, Storage

**Type:** Retail/Commercial

**Bathrooms:** 2 baths

**Year built:** 1975

**Lot Size Acres:** 5 acres

**County:** Manistee



### Call us now

Phone: (231)730-8781  
 Email: [tuckerbennerteam@gmail.com](mailto:tuckerbennerteam@gmail.com)  
 Address: 2747 Lakeshore Drive, Twin Lake, MI 49457



---

## Building Details

**Building Area Total:** 7900 sq ft

**Number Of Units Total:** 2

**Construction Materials:** Stucco, Metal Siding

**Sewer:** Septic System

**Stories Total:** 1

**Building Features:** Fenced Storage, Outdoor Storage, Over Head Crane, Security System

**Roof:** Composition, Metal, Concrete

**Number Of Buildings:** 2

**Basement:** Partial

---

## Amenities & Features

**Inclusions:** 1

**Utilities:** Phone Available, Propane Connected, Electric Connected

**Parking Features:** Asphalt, Driveway

**Water Source:** Well

**Fireplaces Total:** 2

---

## Fees & Taxes

**Tax Assessed Value:** \$49,893

**Tax Year:** 2022

**Tax Annual Amount:** \$2,291.36

---

## School Information

**High School District:** Manistee

---

## Miscellaneous

**Road Surface Type:** Paved

**CrossStreet:** Orchard Hwy, Cohadas Rd

**Listing Terms:** Contract, Cash



### Call us now

Phone: (231)730-8781

Email: tuckerbennerteam@gmail.com

Address: 2747 Lakeshore Drive, Twin Lake, MI 49457

