

# 3081, OVERRIDGE, ANN ARBOR, MI, 48104

<https://tuckerbenner.com>

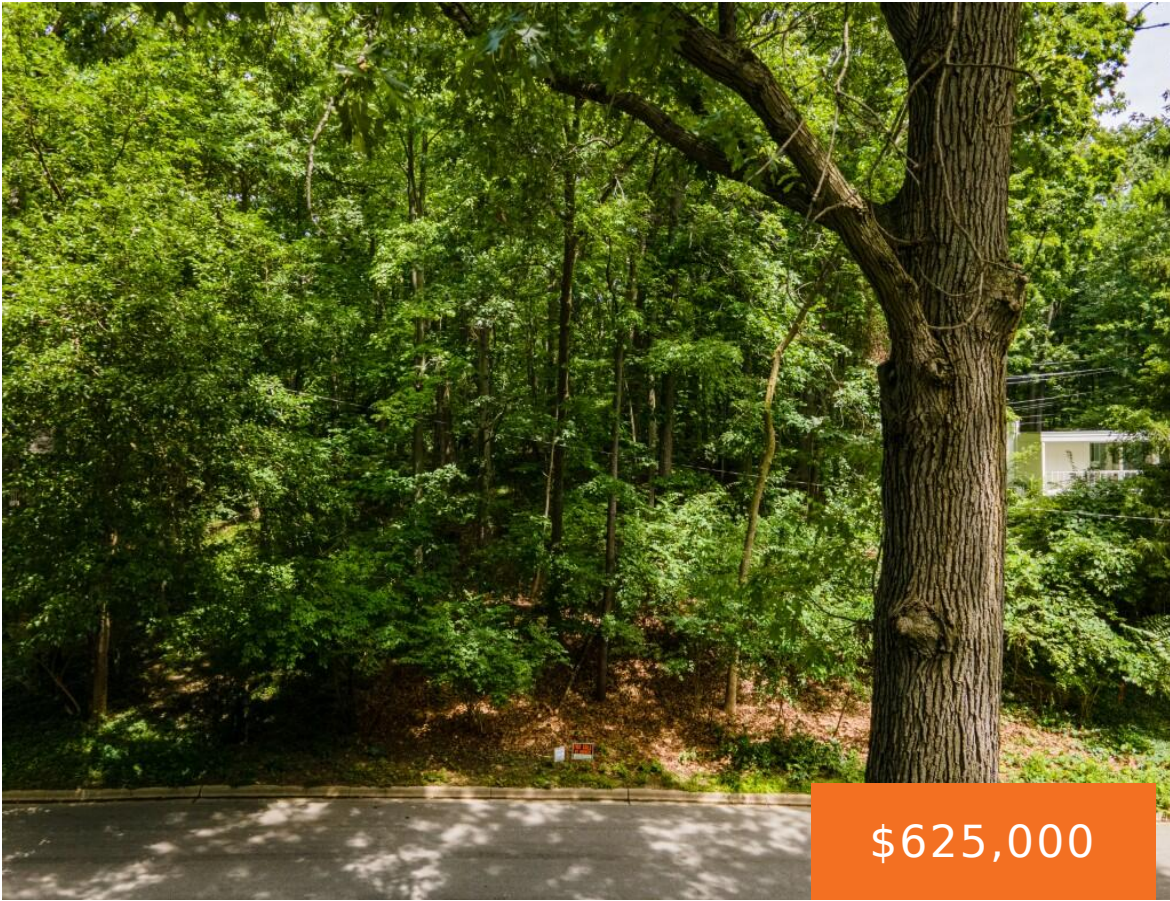

\$625,000

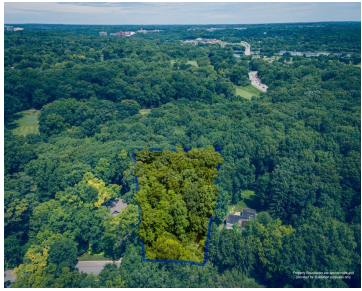

Wonderful opportunity to build the home of your choice on a wooded lot in the heart of Ann Arbor surrounded by nature. This beautiful Ann Arbor Hills parcel backs up to Huron Hills Golf Course and offers woods, privacy and location in an area of fine homes. Consistent with adjacent properties, the building structure is [...]

- 0 baths
- Lot
- Land
- Active



## Basics

**Category:** Land

**Status:** Active

**Lot size:** 0.46 sq ft

**Lot Size Acres:** 0.46 acres

**Type:** Lot

**Bathrooms:** 0 baths

**Subdivision Name:** Woodhaven Hills

**County:** Washtenaw



### Call us now

Phone: (231)730-8781  
 Email: [tuckerbennerteam@gmail.com](mailto:tuckerbennerteam@gmail.com)  
 Address: 2747 Lakeshore Drive, Twin Lake, MI 49457



---

## Building Details

**Current Use:** Residential

---

## Amenities & Features

**Utilities:** Phone Available, Storm Sewer, Water Available, Sewer Available, Natural Gas Available, Electricity Available, Cable Available, None

**Lot Features:** Buildable, Wooded

---

## Fees & Taxes

**Tax Assessed Value:** \$134,400

**Tax Year:** 2024

**Tax Annual Amount:** \$7,154.31

---

## School Information

**High School District:** Ann Arbor

**HighSchool:** Huron

**Middle Or Junior School:** Tappan

**Elementary School:** Burns Park

---

## Miscellaneous

**Road Surface Type:** Paved

**CrossStreet:** Arlington & Override

**Listing Terms:** Cash, Conventional



### Call us now

Phone: (231)730-8781

Email: tuckerbennerteam@gmail.com

Address: 2747 Lakeshore Drive, Twin Lake, MI 49457

