

3127, ELK ANTLER, PLAINWELL, MI, 49080

<https://tuckerbenner.com>

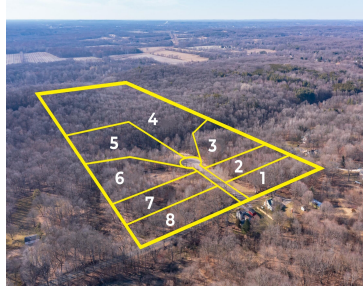

Beautiful Hunter's Ridge Development with wooded walkout sites available; some sites offer creek frontage. Each unit will need to have its own on-site private well, septic system and drain field. This is a residential site condominium development with minimum square footage requirements. Build your dream home today. Please contact listing agent for further details.

- 0 baths
- Lot
- Land
- Active



Basics

Category: Land

Status: Active

Lot size: 1.6 sq ft

County: Kalamazoo

Type: Lot

Bathrooms: 0 baths

Lot Size Acres: 1.6 acres



Call us now

Phone: (231)730-8781
 Email: tuckerbennerteam@gmail.com
 Address: 2747 Lakeshore Drive, Twin Lake, MI 49457



Amenities & Features

Utilities: Phone Available, None

Association Amenities: Pets Allowed

Lot Features: Rolling Hills, Site Condo, Buildable, Cul-De-Sac, Wooded

Fees & Taxes

Tax Assessed Value: \$3,722

Association Fee Frequency: Annually

Association Fee: \$575

Tax Year: 2024

Tax Annual Amount: \$190

Association Fee Includes: Snow Removal

School Information

High School District: Plainwell

Miscellaneous

Road Surface Type: Paved

CrossStreet: E B Ave & 22nd

Listing Terms: Cash, Rural Development, Conventional



Call us now

Phone: (231)730-8781

Email: tuckerbennerteam@gmail.com

Address: 2747 Lakeshore Drive, Twin Lake, MI 49457

